

AMC Visiotherm & Audiotherm

DE	Gebrauchsanleitung	2
EN	User Manual	15
IT	Istruzioni per l'uso	28
ES	Manual de instrucciones	41
FR	Notice d'utilisation	54
NL	Gebruiksaanwijzing	67
HR	Uputa za uporabu	80
SI	Navodila za uporabo	93
SK	Návod na používanie	106
TK	Kullanım kılavuzu	119

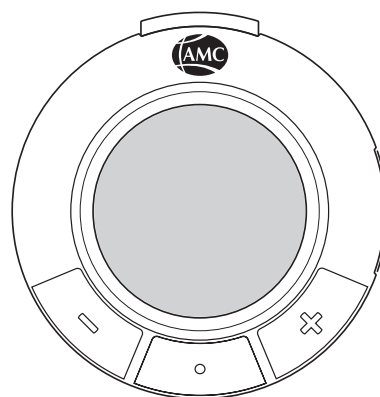

Eat better.
Live better.

The Premium Cooking System.
www.amc.info

AMC Visiotherm & Audiotherm

User Manual

Table of Contents

1. Visiotherm	
1.1 Intended use and safety	17
1.1.1 Suitable lid	17
1.1.2 Safety	17
1.2 Composition and display	17
1.3 Assembly and first use	17
1.4 Care and Maintenance	18
2. Audiotherm	
2.1 Intended use and safety	18
2.2 Using the Audiotherm for the first time / changing the batteries	19
2.3 Composition and display	20
2.3.1 Composition	20
2.3.2 Display	20
2.4 Features	21
2.4.1 Placing onto the Visiotherm	21
2.4.2 Switching on	21
2.4.3 Setting the time	22
2.4.4 Time-controlled gratinating and baking	23
2.4.5 Setting the kitchen timer	24
2.4.6 Selecting cooking programs	24
2.4.7 Switching the acoustic signal off	25
2.4.8 Removing the Audiotherm from the Visiotherm	25
2.4.9 Switching the Audiotherm off	25
2.5 Additional features	25
2.5.1 Changing the sound	25
2.5.2 Mode for visually impaired people	25
2.5.3 Displaying the software and hardware	26
3. What to do when...	26
4. Care and Maintenance	27
5. Audiotherm and App	27
6. Disposal	27
7. Technical Data	27
8. Declaration of Conformity	27
9. AMC Customer Service	27

The Visiotherm and Audiotherm are exclusively intended for proper use within the household. Hazards may arise from improper use.

Before using the Visiotherm and Audiotherm, please read the User Manual carefully – especially the information on proper use and safety. Retain the User Manual and pass it on to subsequent owners.

Please also carefully read the “Cooking With AMC” brochure and the corresponding user manuals of the other AMC products that are used with it.

Symbol Meanings



Instructions important for safety. Non-observance can lead to injury or damage.



Poor operating condition or improper use.



Good operating condition or proper use.



Useful user information.



Environmental protection, ecology, and economy information.



Process steps are highlighted with an arrow.

Visiotherm and Audiotherm User Manual version: 07/2020

1. Visiotherm

When placed on AMC lids, the Visiotherm measures the temperature of the respective pot or pan and shows it on the display. Visiotherm thus visually indicates whether the desired temperature in the pot or pan has been reached.

1.1 Intended use and safety

1.1.1 Suitable lid

The Visiotherm is suitable for all AMC pot and pan lids.



1.1.2 Safety

- Note heat-related hazards; when the lid is hot, touch only the Visiotherm.
- The Visiotherm is equipped with a magnet to transmit the temperature. A pacemaker can be switched to test mode and cause discomfort if it is less than 2 cm from the Visiotherm viewing window.
- Credit cards, EC cards, data carriers, hearing aids or mechanical watches can be affected if they are less than 2 cm from the viewing window of the Visiotherm.
- Do not use the Visiotherm in the oven or microwave.

1.2 Composition and display

- 1 Indicator
- 2 Roasting window
- 3 Turning point
- 4 Vegetable window
- 5 "Vegetable" temperature range
- 6 Stop window

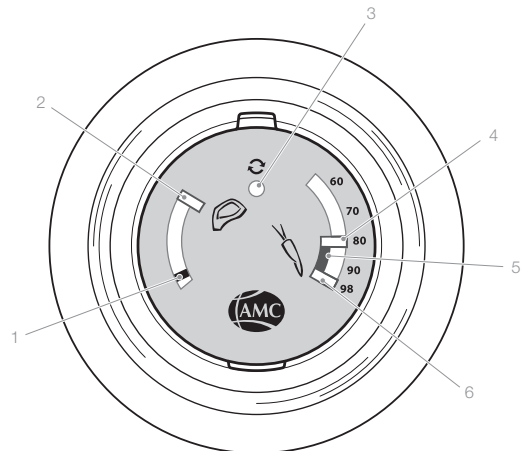

Follow the descriptions and tips in the "Cooking with AMC" brochure.

1.3 Assembly and first use

- ➔ Before using the Visiotherm for the first time, wipe it down with a damp cloth.
- ➔ Screw the Visiotherm onto the lid.

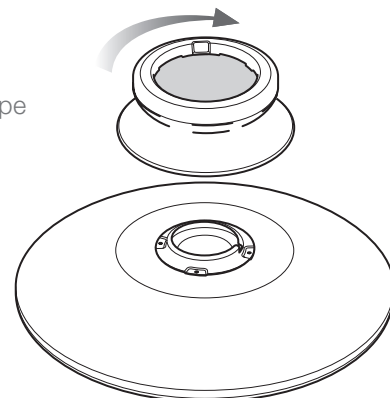

1.4 Care and Maintenance

- ➔ Unscrew the Visiotherm from the lid; clean both in the dishwasher or by hand.
- ➔ Use standard household machine-friendly cleaners for the dishwasher.
- ➔ When cleaning by hand, use a dishcloth or soft sponge and neutral detergent.



2. Audiotherm

2.1 Intended use and safety

Together with the Visiotherm, the Audiotherm monitors the cooking process. The Audiotherm displays the temperature in the pot as measured by the Visiotherm. It serves as an acoustic temperature and cooking time monitor and facilitates controlled cooking with the Navigenio.

Suitable lid

- Lid with Visiotherm
- EasyQuick steam cooking lid with Visiotherm E
- Quick cooking lid “Secuquick softline” with Visiotherm S



Avoid damage and improper use.

- Do not use the Audiotherm in the oven or microwave. Do not expose it to temperatures above 70 °C.
- Never immerse the Audiotherm in water or put it in the dishwasher.
- The Audiotherm is used to monitor or control the cooking process. Use the Audiotherm for this purpose only. Hazards may arise from improper use.
- The Audiotherm contains batteries. Batteries must not get into the hands of children, as they can be swallowed.
- Use only recommended, equivalent-type batteries (as according to Section 5).
- Do not attempt to recharge non-rechargeable batteries.

Please also refer to the EasyQuick, Secuquick softline, and Navigenio user manuals as well as the notes and tips in the “Cooking With AMC” brochure.



Supervision

- The cooking process must be supervised. To monitor the cooking process acoustically, use the Audiotherm only when within earshot of it.
- Unattended, uncontrolled cooking can lead to overheating. Food can spoil, and the pot can be damaged or destroyed. Risk of accidents and fire.
- The device can be used by children who are at least 8 years of age, persons with limited physical, sensory, or mental abilities, as well as persons lacking in experience or knowledge. They nevertheless must be supervised or instructed in how to use the device safely and must understand the risks involved. This also applies to acoustic monitoring by the visually impaired (see Section 2.5.2).

2.2 Using the Audiotherm for the first time / changing the batteries

First use:

The Audiotherm comes with two batteries (type as per Section 5).
Insert the batteries before first use.

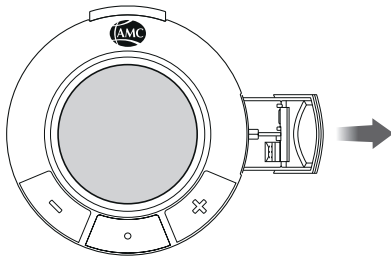

➔ Open the battery compartment and pull out the battery holder.

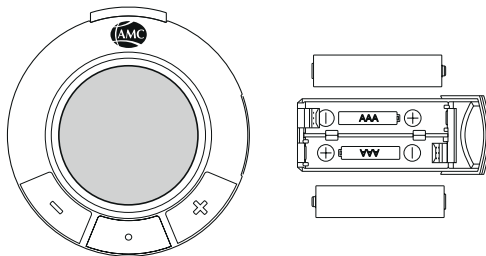

➔ Insert the batteries correctly as shown.

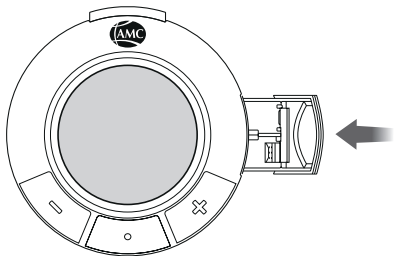

➔ Insert the battery holder into the Audiotherm. When it clicks, it's closed.

Changing the batteries:

If the battery indicator is visible in the display, it's time to replace the batteries.



Dispose of used batteries as according to local regulations!

2.3 Composition and display

2.3.1 Composition

- 1 Unlock button
- 2 **-**-button
- 3 Middle button
- 4 **+**-button

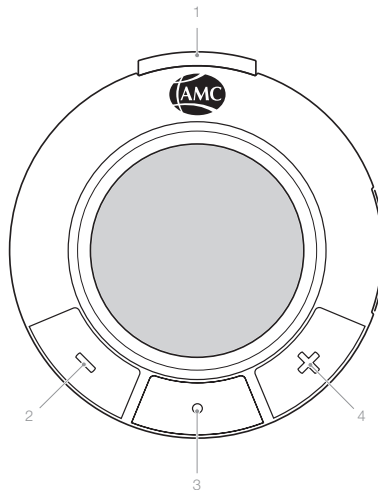

2.3.2. Display

- 1 Soft symbol
- 2 Roasting symbol
- 3 Vegetable symbol
- 4 Orientation line
- 5 Turning point symbol
- 6 Turning point
- 7 Steam symbol
- 8 60 °C symbol
- 9 Minus display

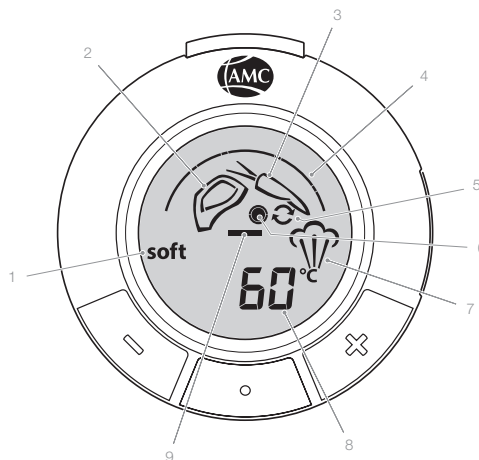

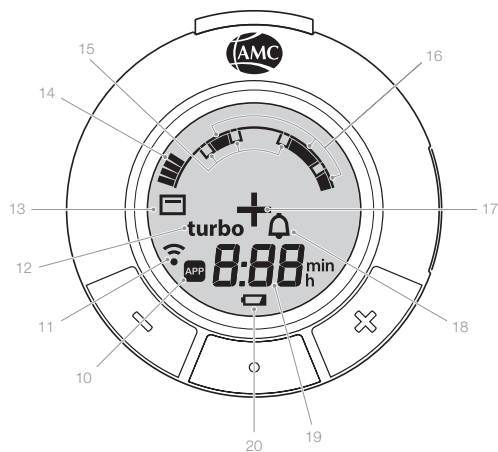

- 10 "App" connection
- 11 "Navigenio" connection
- 12 Turbo symbol
- 13 Bake symbol
- 14 Temperature scale
- 15 Action points
- 16 Temperature ranges
- 17 Plus display
- 18 Kitchen timer symbol
- 19 Time display
- 20 Battery display



2.4 Features

The AMC Cooking System includes various cooking methods, for which the Audiotherm can be used in two different ways.

Manual cooking with the Visiotherm and Audiotherm:

- The Audiotherm displays the current temperature and emits acoustic signals  to indicate when something needs to be done. The Audiotherm display shows what needs to be done.
- Via an acoustic signal , the Audiotherm indicates that the cooking time has elapsed.
- The user is responsible for operating the cooktop.

Self-controlled cooking:

When cooking on the “Navigenio” mobile hotplate, the Audiotherm facilitates self-controlled cooking.

- Via a radio link to the Navigenio, the Audiotherm independently controls the entire cooking process.
- After switching on the Navigenio to “A”, the Navigenio’s operation is taken over by the Audiotherm.
- The Audiotherm emits an acoustic signal  to indicate that the set cooking time has elapsed.



All cooking features (with the exception of planned cooking and the 60 °C program) can be carried out manually or in a self-controlled manner.

Be sure to follow the descriptions and tips in the “Cooking with AMC” brochure.

2.4.1 Placing onto the Visiotherm

- ➔ With the push-button facing upward, place the Audiotherm onto the Visiotherm and let it click into place.

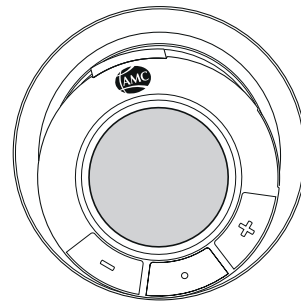

2.4.2 Switching on

- ➔ Press any button.

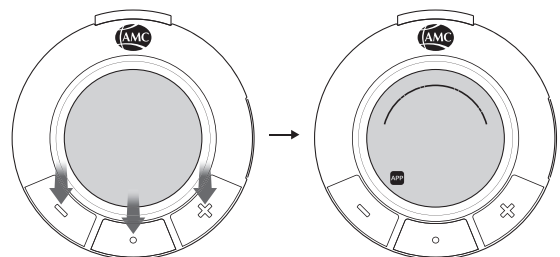

2.4.3 Setting the time



Times can be set before or after the Audiotherm is placed onto the Visiotherm (or before or after the respective cooking program is selected). To facilitate entry, all times that appear when the buttons are pressed for the first time are preset values.

Cooking time

To monitor the cooking time, it can be entered into the Audiotherm. The set cooking time begins as soon as the respective cooking temperature has been reached.

➔ Switch on.

➔ Press the **+**-button to select a short time (0:10) or to increase the desired cooking time (press and hold for fast mode),

or

➔ Press the **-**-button to select a long time (1:00) or to reduce the desired cooking time (press and hold for fast mode).

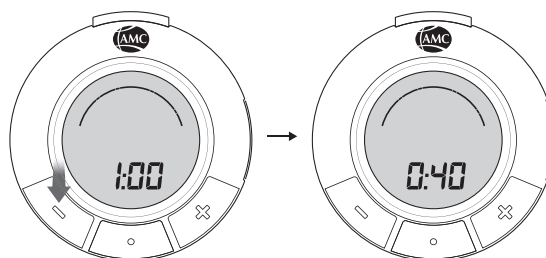
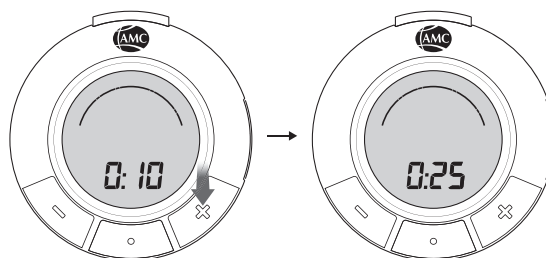

Time setting "P"

➔ After switching on, press the **-**-button and then the **+**-button.

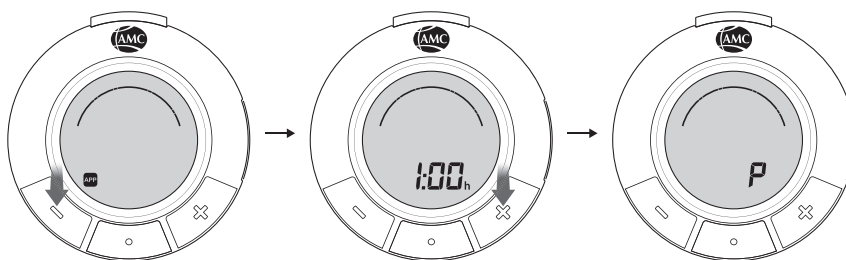

If no time is input, the Audiotherm controls the temperature for the desired cooking process with no time limit. The cooking time can also be set after the cooking process has begun and can be changed whenever desired.

Be sure to follow the descriptions and tips in "Cooking with AMC" Brochure.

“+” planned cooking

In controlled operation, the Audiotherm can be set to level “A” with the Navigenio so that the cooking process starts at a later time (start delay).

➔ Switch on and enter the cooking time.

- As soon as “+” appears in the display.

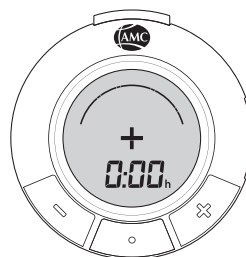

➔ Press the +-button to select a short start-delay time (1:00) or to increase the desired time (press and hold for fast mode),

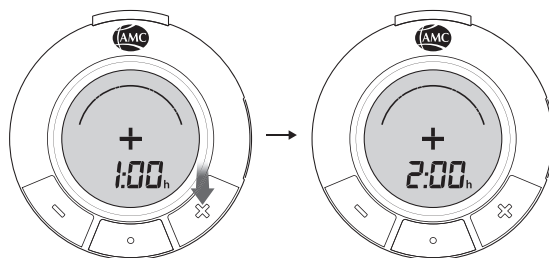

or

➔ Press the -button to select a long start-delay time (8:00) or to reduce the desired time (press and hold for fast mode).

- With “+”, the display alternates between the cooking time and the start-delay time.

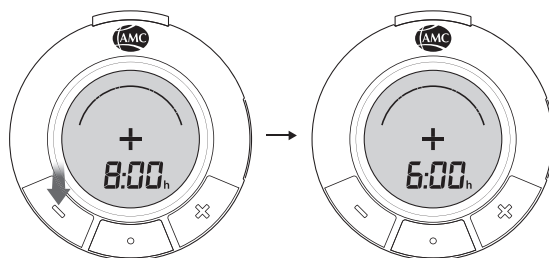

The set start-delay time can be changed whenever desired.

The start-delay time or cooking time can always be changed whenever it is shown in the display.

Be sure to follow the descriptions and tips in the “Cooking with AMC” brochure.

2.4.4 Time-controlled gratinating and baking

To monitor the time, the time can be entered into the Audiotherm. The time can be entered when the Navigenio (which must be switched on to the desired level) flashes blue/red.

➔ Press the middle button until the Baking symbol appears.

➔ Press the +-button to increase the desired time (press and hold for fast mode).

➔ Press the -button to reduce the desired time (press and hold for fast mode).

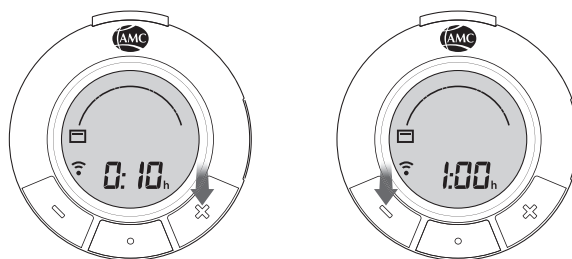

2.4.5 Setting the kitchen timer

- ➔ Switch on and press middle button.

Example: The Audiotherm has not been placed on.

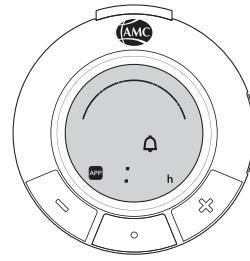

- ➔ Press the **+**-button to increase the desired time (press and hold for fast mode),

or

- ➔ Press the **-**-button to reduce the desired time (press and hold for fast mode)

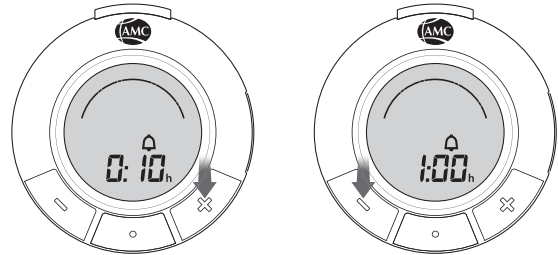

Be sure to follow the descriptions and tips in the “Cooking with AMC” Brochure.

2.4.6 Selecting cooking programs

- ➔ By pressing the middle button, cooking programs can be selected.

Example: The Audiotherm is placed onto the Visiotherm.

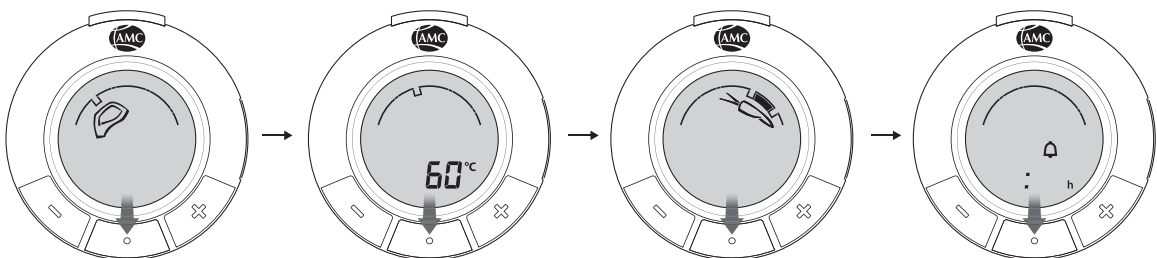

Programs can be selected before or after the Audiotherm is placed onto the Visiotherm.

2.4.7 Switching the acoustic signal off

- ➔ Press any button.
Otherwise the acoustic signal switches off after 1 minute.

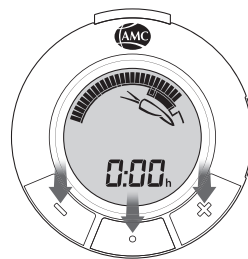

2.4.8 Removing the Audiotherm from the Visiotherm

- ➔ Press the unlock button and remove Audiotherm.

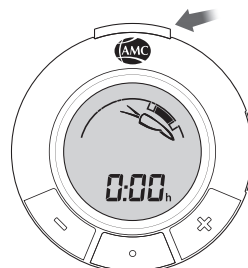

2.4.9 Switching the Audiotherm off

- ➔ Keep middle button pressed for about 2 seconds.

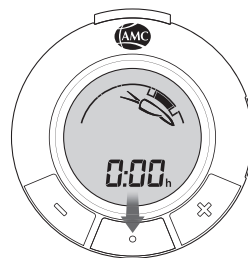

After use, always remove the Audiotherm from the Visiotherm. Never immerse the Audiotherm in water or put it in the dishwasher.

2.5 Additional features

2.5.1 Changing the sound

- ➔ Switch on.
- ➔ Simultaneously press the **+**-button and middle button.

- A Melody (S: 1) or Beep (S: 2) can be selected.

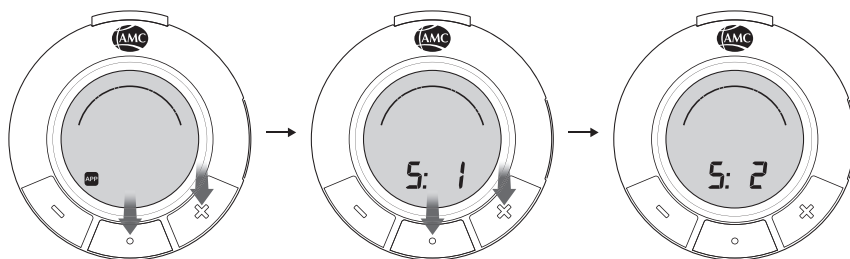

2.5.2 Mode for visually impaired people

The Audiotherm has a mode for the visually impaired (S: 0). It can be activated with the Audiotherm app. In this mode, when selecting the cooking programs a different sequence of sounds is played for each one. In addition, the respective sounds for “increase level” (**+**) and “decrease level” (**-**) are different. All other sounds match the “Beep” mode (S: 2).

2.5.3 Displaying the software and hardware

- ➔ Simultaneously press and hold the -button and middle button.

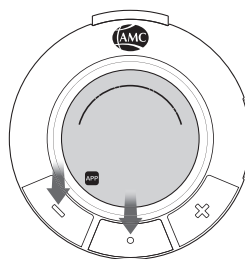

- After a short indication of all the display symbols, the software number (e.g. 012) and then the hardware number (e.g. H01) appears.

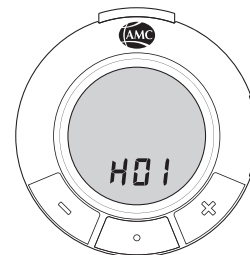
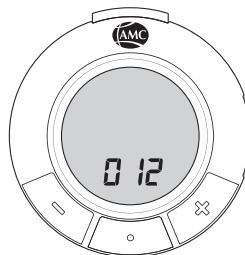

3. What to do when...

...a cooking program is selected that is not available on the Visiotherm being used?

When the Audiotherm is put on, an error tone sounds and the selected cooking program disappears from the display.

- ➔ Check to see which program should be used to cook.

...the Audiotherm that has been set to a program loses contact with the Visiotherm?

An error tone sounds.

- ➔ Join the Audiotherm and Visiotherm together correctly.

...the following error messages appear?

E: 01

Audiotherm hardware error.

- ➔ Contact customer service.

E: 02

- ➔ Check that all components are correctly positioned and restart the cooking process.

E: 03

- ➔ Switch the Audiotherm off. Remove any sources of magnetic interference from the surrounding area.
- ➔ Switch the Audiotherm on and restart the cooking process.
- ➔ If the error occurs repeatedly, contact customer service.

E: 04

Navigenio hardware error.

- ➔ Contact customer service.

4. Care and maintenance

- Use only a cloth that's been moistened with a little rinsing water to wipe down the Audiotherm.
- Maintain and clean the Audiotherm regularly to ensure its functionality and safety.
- Should the Audiotherm ever fall into water:
 - ➔ Switch off the Audiotherm immediately. Open the battery compartment, remove the batteries, and dry any visible water with a cloth. Leave the opened Audiotherm and battery compartment to dry for at least two days.



5. Audiotherm and App

The Audiotherm can be operated via an app.

6. Disposal



The packaging, Audiotherm, and Visiotherm do not belong in household waste. The materials are recyclable. Carry out disposal in an environmentally friendly manner and according to local regulations at suitable collection points.



7. Technical Data

- 1.5 V batteries size AAA/LR03/Micro (e.g. alkaline)
- Rechargeable 1.2 V batteries of the same size (e.g. NiMH)



8. Declaration of Conformity

The Audiotherm meets the CE requirements according to the European Radio Equipment Directive 2014/53/EU. A complete Declaration of Conformity can be obtained from the address listed in the "AMC Customer Service" section below.

9. AMC Customer Service

If you have any questions or suggestions, please contact AMC Customer Service.

Customer service

AMC International
Alfa Metalcraft Corporation AG
Buonaserstrasse 30
6343 Rotkreuz, Switzerland
+41 41 - 799 52 22
info@amc.info