

CLASS 21

ELECTROSURGICAL



WALLACH

Disposable, Extra-rigid Loop and Ball Electrodes (ER series)

Wallach offers a wide variety of sterile, single-use electrodes, all made in the U.S.A. and fashioned out of high-quality tungsten wire.

McKesson #	Description	Packaging	Mfr #
317967	3mm Ball	5/box	909038
221813	5mm Ball	5/box	909003
475743	5mm Ball (6cm Shaft)	5/box	909136
449031	10mm x 7mm Loop	5/box	909133
513554	15mm x 5mm Loop	5/box	909134
294068	15mm x 8mm Loop	5/box	909011
221553	10mm x 10mm Loop	5/box	909007
222759	20mm x 8mm Loop	5/box	909013
557540	0.8mm Dia. X 16mm	5/box	909135
449030	10mm x 10mm Square	5/box	909131
520536	0.8mm Dia. X 25.4mm Large Needle	5/box	909005
209135	10mm x 8mm Square	5/box	909017
435993	20mm x 10mm Loop	5/box	909132
221554	20mm x 15mm Loop	5/box	909009

KICK BUCKET



MCKESSON

entrust™ Performance Stainless Steel Kick Bucket with Frame

360° flat bumper on frame. Heavy-duty, non-corrosive stainless steel construction. Not made with natural rubber latex.

McKesson #	Description	Packaging	Mfr #
407338	Kick Bucket	each	81-48711

LAP SPONGES



MCKESSON

Medi-Pak™ Lap Sponges, Prewashed

100% cotton. X-Ray detectable. Sterile. Single use. Not made with natural rubber latex.

Soft Pack

McKesson #	Description	Packaging	Mfr #
281500	12" x 12"	5/pack, 40 pack/case	16-2112121
291446	18" x 18"	5/pack, 40 pack/case	16-2118181

Rigid Pack

McKesson #	Description	Packaging	Mfr #
640985	18" x 18"	5/pack, 20 pack/case	16-2118182

INFILTRATION PUMPS

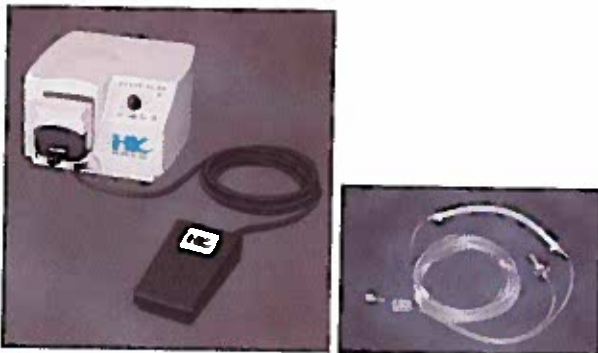

Klein Infiltration Pump

An essential device designed specifically to expedite the delivery of tumescent anesthesia. Delivers high volumes of tumescent anesthesia, therefore maximizing patient comfort and reducing physician infiltration time. The only infiltration pump with a non-conductive roller head, a feature that ensures safety during procedures. The pumps are stackable for conserving space. Includes instructional DVD. 1 year warranty.

McKesson #	Description	Packaging	Mfr #
887771	Klein Infiltration Pump	each	KJP II

Infiltration Tubing

McKesson #	Description	Packaging	Mfr #
863937	Single Spike, 15.5 ft	10/box	ITS-10
863938	Single Spike, 15.5 ft	20/box	ITS-20
882686	Single Spike, No-Drip, 15.5 ft	10/box	CVT-10
957266	Single Spike, No-Drip, 15.5 ft	20/box	CVT-20
863936	Double Spike, 15.5 ft	20/box	ITD-20

Trash Can with Plastic Liner entrust™ 32 Quart White Steel Step On Square

[View Item](#)



McKesson # 407341

UOM EA/1

Stock Stocked

Actual Product May Vary. See Product Details and Features for Specifications

Product Features

- entrust™ Waste Can
- Steel outer can and lid.
- Square
- 11-1/2D X 12-1/4W X 18-1/4H Inch
- 32-quart capacity (8 gallon).
- White enamel finish.
- Steel cans come with removable plastic inner liner and are available in enamel or stainless steel finishes.
- Step-on foot pedal opens lid.
- Perfect for exam rooms, restrooms, and front office areas.
- Meets OSHA standard on bloodborne pathogens.
- Hazardous waste label included.
- Not Made With Natural Rubber Latex.
- Packaged: Each

Manufacturer	McKesson Brand
Manufacturer #	81-35266
Brand	Entrust™
Application	Trash Can with Plastic Liner
Capacity	32 Quart
Color	White
Lid Opening Type	Step On
Lid Type	Self-Closing
Material	Steel
Size	11-1/2D X 12-1/4W X 18-1/4H Inch
Style	Square
UNSPSC Code	47121702
Latex Free Indicator	Not Made with Natural Rubber Latex

Questions? Contact Customer Service @ [866-625-2679](tel:866-625-2679)

[Login to SupplyManager](#)
[Privacy Policy](#)
[Terms of Use](#)

More from McKesson
[Relay Health](#)
[Primary Care](#)
[Surgery Center](#)

© 2016 McKesson Corporation

MCKESSON MEDICAL-SURGICAL, INC. - PROPRIETARY AND CONFIDENTIAL INFORMATION

Confidentiality Notice: This e-mail message, including any attachments, is for the sole use of the intended recipient(s) and may contain confidential and proprietary information. Any unauthorized review, use, disclosure or distribution is prohibited. If you are not the intended recipient, please contact the sender at SupplyManager@mckesson.com and then permanently destroy all copies of the original message.