

Administration Instructions for ENDOMETRIN

Simple and easy to use

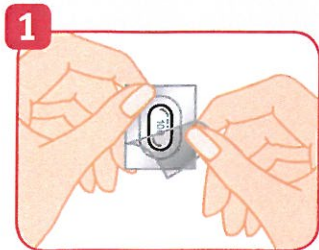

1 Unwrap the applicator and the ENDOMETRIN insert.

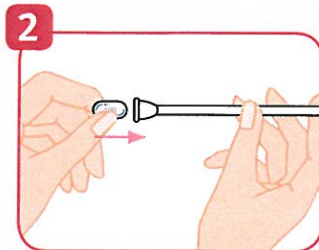

2 Put one ENDOMETRIN insert into the space provided at the end of the applicator. The insert should fit snugly and not fall out.

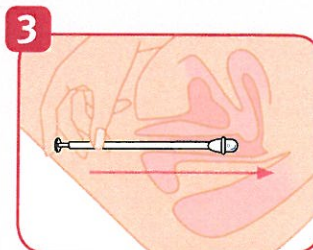

3 When using ENDOMETRIN, you may be standing, sitting, or lying on your back with your knees bent. Gently place the thin end of the applicator well into the vagina.

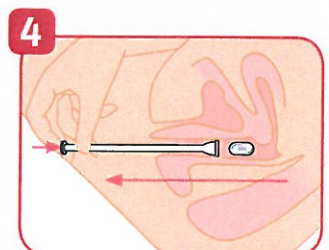

4 Push the plunger to release the ENDOMETRIN insert. Remove the applicator and throw it away in a waste container.

Note: If you miss a dose of ENDOMETRIN, use it as soon as you remember, but do not use more than the recommended daily dose prescribed by your healthcare provider.

ABOUT ENDOMETRIN

ENDOMETRIN is a vaginal insert that contains 100 mg of progesterone, one of the hormones essential in helping you to become and stay pregnant.

Each ENDOMETRIN insert comes with an individually wrapped sterile applicator, which should be discarded after use.

Your doctor may prescribe you ENDOMETRIN administered 2 or 3 times a day, starting after egg retrieval. Upon a positive pregnancy test, ENDOMETRIN may be continued for up to 10 weeks.

ENDOMETRIN can be taken 2 or 3 times a day without interrupting your schedule (ie, in the morning, after work, and at bedtime).

HOW ENDOMETRIN WORKS

ENDOMETRIN is designed to be placed in the vagina. The effervescent tablet is made to dissolve and deliver progesterone to the vaginal tissue.

Please read the product information enclosed with ENDOMETRIN. However, this does not replace discussions with your healthcare provider.

Please see Indication and Important Safety Information on back page.

DISSOLVES. DELIVERS. DONE.

Endometrin[®]
(progesterone) Vaginal Insert 100mg

FERRING
PHARMACEUTICALS

Provided as an educational service by



Please visit www.endometrin.com for more information and to view these instructions in additional languages.

ENDOMETRIN® (progesterone) is a vaginal insert that contains the hormone progesterone, one of the hormones essential for helping you to become and to stay pregnant. ENDOMETRIN is for women who need extra progesterone while undergoing treatment in an Assisted Reproductive Technology (ART) program.

Important Safety Information

Do not use ENDOMETRIN if you:

- Are allergic to anything in ENDOMETRIN
- Have unusual vaginal bleeding that has not been evaluated by a doctor
- Currently have or have had liver problems
- Have or have had blood clots in the legs, lung, eyes, or elsewhere in your body

Progesterone can increase your chance of getting blood clots. Blood clots can be serious and lead to death. Serious blood clots include those in the legs, lungs, eyes, heart, and brain.

Call your doctor and get medical help right away if you have: persistent lower leg pain, sudden shortness of breath, coughing up blood, sudden blindness (partial or complete), severe chest pain, sudden severe headache, vomiting, dizziness, or fainting, weakness in an arm or leg, or trouble speaking, yellowing of the skin and/or white of the eyes indicating possible liver problems.

Common side effects seen with ART and ENDOMETRIN included pelvic pain after surgery, abdominal pain, nausea, and swollen ovaries (ovarian hyperstimulation syndrome).

Please see full Prescribing Information or visit www.endometrin.com for more information.

Endometrin®
(progesterone) Vaginal Insert 100mg