

Facet Technologies, the market leaders in the development and manufacture of lancing devices, now offers you...

FELIX LANCING DEVICE

FEATURES:

- Accepts most lancet sizes and types
- 5 adjustable depth settings
- Proven reliability
- Ergonomic styling
- Quiet operation and quick retraction
- Many patients can obtain the required blood volume using shallow depth settings
- Simple and reliable

BENEFITS TO PATIENTS:

- Patients can continue utilizing their preferred lancet
- Easy to handle, minimizes accidental needle sticks
- Minimized pain when sampling
- Unsurpassed performance for optimization of blood sampling
- Designed and manufactured by Facet
- Patient comfort is maximized

PRODUCT	QUANTITY
#0400100	1 device, <u>bagged w/insert</u> ; 50 devices per box
#0400050	Device, <u>Bulk</u> ; 800 devices per case

EASY TO USE

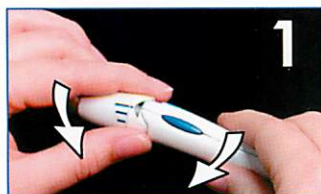

1 "Snap" cap
from body

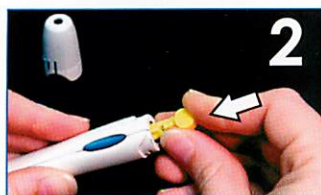

2 Insert lancet
into device

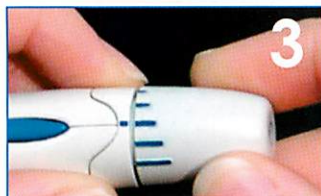

3 Adjust to
proper
depth setting



4 Pull charger
to set device



5 Activate
release
button

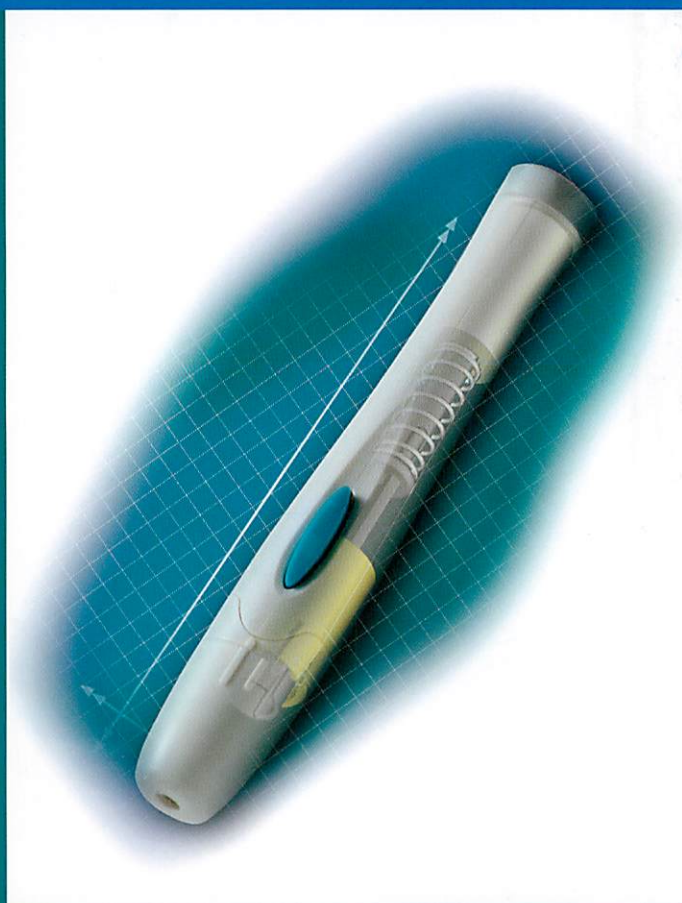

FELIX LANCING DEVICE

So Easy, It's a SNAP!



US Headquarters:

112 Town Park Drive
Suite 300
Kennesaw, GA 30144
Phone: 800.880.9987

European Office:

Unit 7F Mobbs Miller House
Christchurch Road
Northampton NN1 5LL U.K.
phone: +44 1604 638340

www.facettechnologies.com