

Exhibit B



- Home
- About Masimo
- Signal Extraction Pulse Oximetry
- rainbow® Pulse CO-Oximetry
- Root
- rainbow Acoustic Monitoring™
- Capnography & Multigas Monitoring
- Brain Function Monitoring
- Patient SafetyNet Remote Monitoring
- OEM Products & Solutions
- Clinical Evidence
- News & Media
- Investors
- Global Services
- Contact

Other Products ▾

RD SET™

Featuring Masimo SET® Measure-through Motion and Low Perfusion™ Technology



- > Maximizing Patient Comfort
- > Optimizing Clinician Workflow
- > Helping Hospitals Meet Their **Green Initiatives** ♻️

Proud Sponsor of the **Patient Safety Science & Technology Summit**



RD SET Sensors for Patients

Maximizing Patient Comfort

Lightweight sensor with a flat, soft cable

\$1 MILLION
Masimo SET®
Performance
Guarantee



2014 **MASIMO**
ANNUAL REPORT

thank
you



DOWNLOAD NOW



Flat Sensor Cable

- > Flat, lightweight sensor cable with smooth edges lies comfortably on the patient's hand or foot



Lightweight Connector

- > Made from materials that result in a lightweight connector with no moving parts



Small, Thin Optical Components

- > Low profile internal components allow the sensor to better conform to the shape of a finger and may put less pressure on the measurement site
- > Orientation of optical components position the sensor cable comfortably on top of the hand



Tape removed for illustrative purposes

RD SET Sensors for Caregivers

Optimizing Clinician Workflow

Simple to use with enhanced connection and sensor application features for a better user experience

Two Styles of Sensors For Use on Different Patient Types

location of emitter/detector



Fold-over-Style Sensors

- > Available in adult and pediatric sizes
- > Offering a more secure application to the digit and more intuitive sensor alignment



Sensor Graphics to Guide Proper Sensor Application

- > Application graphics printed on top and bottom of sensors to assist with sensor application for optimal performance and ease of sensor removal and reapplication
- > Sensor labels to immediately communicate location of emitter/detector



Wrap-around-Style Sensors

- > Available in adult, pediatric, infant, and neonatal sizes
- > Easily removed and reapplied
- > Suited for patients with long fingernails or finger deformities





Quick Connection

- > Intuitive sensor to cable connection
- > Tactile and audible feedback ensuring proper connection

RD SET Sensors for the Environment

Helping Hospitals Meet Their Green Initiatives

The same Masimo SET® performance with a significant reduction in waste

Sensor Design

- > Lightweight design that results in less material waste

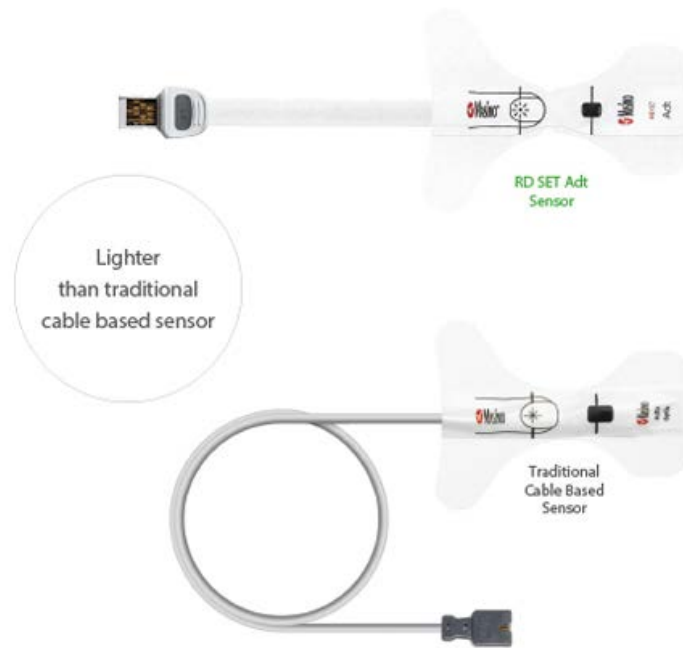

Packaging Design

- > RD SET sensors utilize significantly smaller packaging
- > Lightweight package design is easy to handle
- > Sleek recyclable packaging reduces storage space by 56%

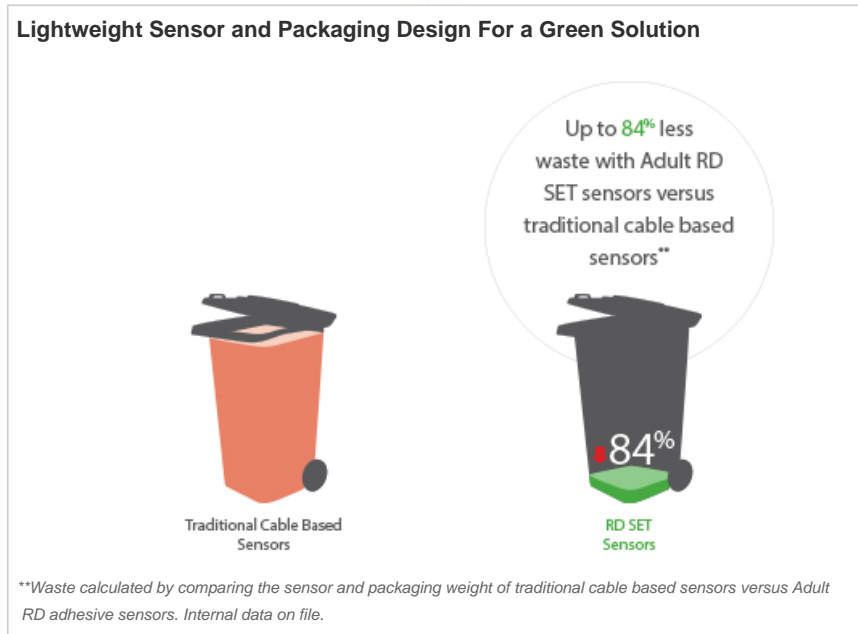

Application



RD SET Adt
finger application



RD SET Pdt
finger application



RD SET Inf
thumb application



RD SET Inf
foot application



RD SET Inf
foot application

Disposable Sensors



RD SET Adt



RD SET Pdt



RD SET Neo



RD SET Inf



RD SET NeoPt



Masimo's SofTouch line of sensors is designed to be used whenever skin sensitivity issues are a concern, such as with extremely low birth weight infants. Masimo SofTouch sensors incorporate soft foam and VelAid hook and loop attachment wraps that come in a variety of configurations to address a wide range of clinical uses.

Resources



Brochure
RD SET Sensors