

# INSTALLATION INSTRUCTIONS

## AB-3039 TRITON CLAMP ASSY 5/8" Stainless Band Mount

### Tools Required:

1/2", 5/8" Sockets, 11/16" Deep Socket, 5/32" Allen socket  
3/8" Open End Wrench, Dead blow Hammer, Pliers,  
Band Cutter, Torque Wrench, Hacksaw

Power tools can be used if care is given to not exceed torque values. Best practice is to lightly snug the fasteners down with power tools and torque to specification with a torque wrench. Using anti seize on stainless to stainless connections is mandatory when using power tools as the heat from rapid assembly will cause galling and seizure of the hardware.

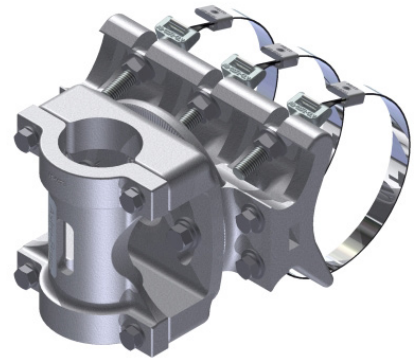

**For less than 4" Diameter Poles:** Insert the band from the top of the casting (Figure 1)

**For 4" and larger Diameter Poles:** Insert the band from the bottom of the casting (Figure 1)

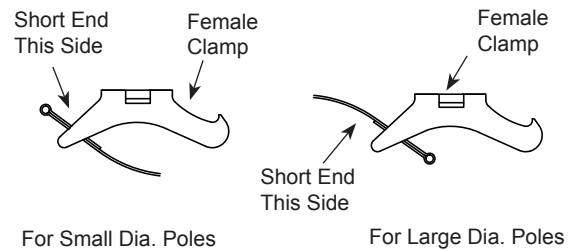

Figure 1

### Attaching Clamp Kit to Mast Arm or Pole

1. Remove the tube saddle, saddle clamp, and adapter plate from the assembly.
2. Thread the bands through the clamp as shown in Figure 1 and place the female clamp on top of the mast arm. (Figure 2)
3. Place a clamp screw assembly in one of the pawls of the female clamp body with the hex nut flush with the end of the clamp screw threads. (Figure 2)
4. Bend the stainless band around the mast arm using the dead blow hammer to form the band to it tightly.

**Note:** It is critical to have the band as tight against the mast arm as possible.

5. Mark the band at the point it crosses the clamp screw head and cut the band 6" past the mark. (Figure 2)
6. Slide a band buckle on the band with the set screw to the outside. (Figure 3)
7. Slide the clamp screw on the band with the stud pointing away from the mast arm.
8. Center the clamp screw on the mark and bend the band to the inside 180 degrees. (Figure 3)

**Caution:** Make certain measurements are correct BEFORE bending the band. Once the band is bent, DO NOT straighten and re-bend; replace with a new band. The bending process weakens the band and rebending will cause fatigue resulting in a loss of strength in the band.

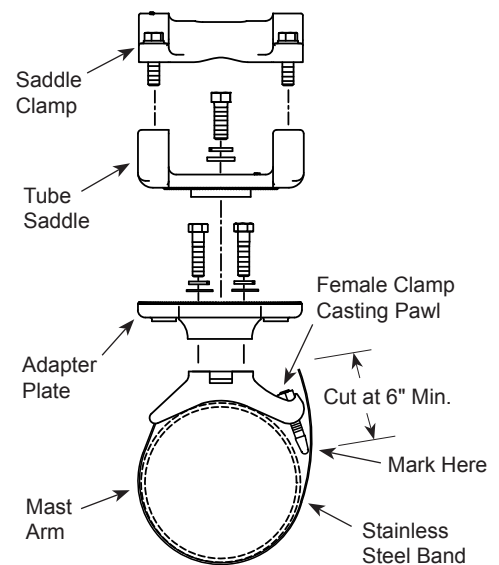

Figure 2

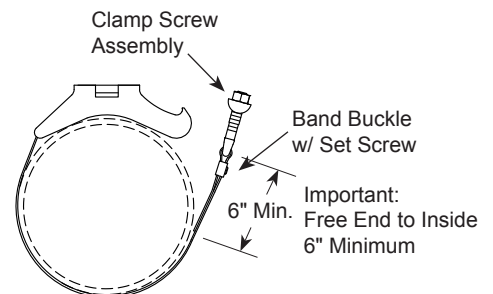

Figure 3

Continued on back



# INSTALLATION INSTRUCTIONS

## AB-3039 TRITON CLAMP ASSY 5/8" Stainless Band Mount

Continued from front

9. With a pair of pliers, crimp the bend in the band around the clamp screw and slide the band buckle over the free end of the band and position as close to the clamp screw assembly as possible. Torque the set screw in the band buckle to 13 ft-lb. (Figure 4)

**Note:** Make certain the free end of the band is turned to the inside and is a minimum of 6" long as shown in Figure 3.

10. Feed the wiring through the center of the clamp and position on mast arm as desired.
11. Insert the clamp screw assembly in the pawl of the female clamp from which it was removed and snug the nut to hold the bracket in position. Use the dead blow hammer to form the band as necessary.
12. Repeat steps 3 through 11 for second and third band.
13. Plumb and level the bracket and starting with the center band torque each 7/16" clamp screw nut to 22 ft-lb. DO NOT OVERTIGHTEN. (Figure 4)
14. Position the adapter plate on the clamp and install the (4) 3/8" hex head bolts, flatwashers, and lock washers and torque to 22 ft-lb . DO NOT OVERTIGHTEN. (Figure 4)

### Tube Support Assembly

15. Install all equipment on the 2" support tube.
16. Place the support tube assembly in the saddle and place the saddle clamp in position. Install the (4) 3/8" washers, lock washers, and bolts and torque to 22 ft-lb. DO NOT OVERTIGHTEN. (Figure 5)
17. Install the saddle assembly (with its attachments installed) onto the female clamp and install the (2) lockwashers, washers, and 7/16" bolts.
18. Position the assembly as needed and tighten the (2) 7/16" bolt to 36 ft-lb of torque. DO NOT OVERTIGHTEN.

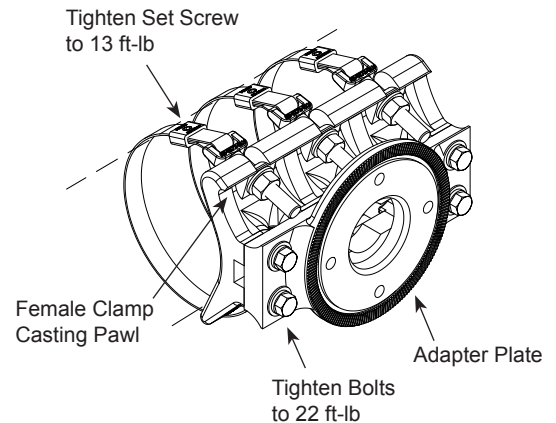

Figure 4

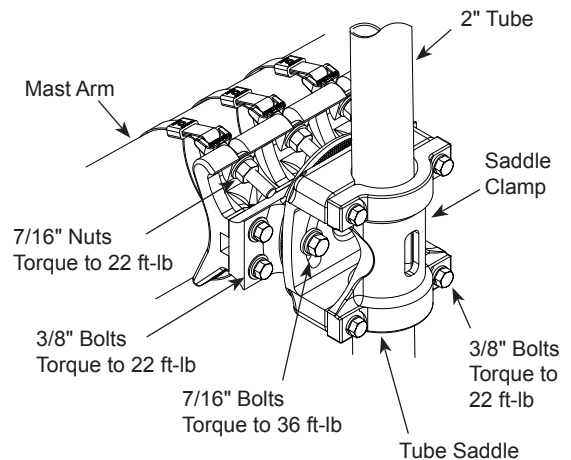

Figure 5

COVERED BY ONE OR MORE OF THE FOLLOWING U.S. PATENTS:  
3586280, 3764099, 3854685, 4659046. OTHERS PENDING.

