

ATTACHMENT A



US00D471428S

(12) **United States Design Patent** (10) **Patent No.:** **US D471,428 S**
Mirick (45) **Date of Patent:** **** Mar. 11, 2003**

(54) **SLOTTED ARROW QUARTER TURN LATCH**

(75) Inventor: **Larry Mirick**, Manhattan Beach, CA (US)

(73) Assignee: **S.P.E.P. Acquisition Corp.**, Rancho Dominguez, CA (US)

(**) Term: **14 Years**

(21) Appl. No.: **29/151,739**

(22) Filed: **Dec. 4, 2001**

(51) **LOC (7) Cl.** **08-07**

(52) **U.S. Cl.** **D8/331**

(58) **Field of Search** D8/330, 331, 338,
D8/341, 343; 292/137, 163, 169, 219, DIG. 37;
70/344, 370, 391, 454

(56) **References Cited**

U.S. PATENT DOCUMENTS

| | | | | | | |
|-----------|---|---|---------|------------------|-------|---------|
| D312,769 | S | * | 12/1990 | Bisbing | | D8/338 |
| 4,978,152 | A | * | 12/1990 | Bisbing | | 292/169 |
| 5,251,467 | A | * | 10/1993 | Anderson | | 70/370 |
| D361,501 | S | * | 8/1995 | Myers | | D8/331 |
| D410,190 | S | * | 5/1999 | Freck | | D8/331 |
| 6,113,160 | A | * | 9/2000 | Johansson et al. | | 292/169 |
| D435,427 | S | * | 12/2000 | Sokurenko | | D8/331 |

OTHER PUBLICATIONS

Quad™ Panel Latch, SOUTHCO Latches and Access Hardware, North American Edition—48 NA, ISO 9001 Quality System, 1998, pp. F13–F16.

Screw-in Quarter Turn (IP 65), B010; Clip-In Quarter Turn, B210; Quarter-Turn (plastic) Clip-In Type, B215, EMKA, Inc., Harrisburg, PA, 1993, 4 pages.

* cited by examiner

Primary Examiner—Brian N. Vinson

(74) *Attorney, Agent, or Firm*—Christie, Parker & Hale, LLP

(57) **CLAIM**

The ornamental design for slotted arrow quarter turn latch, as shown and described.

DESCRIPTION

FIG. 1 is a top right perspective view of the slotted arrow quarter turn latch of the invention;

FIG. 2 is a top plan view of the slotted arrow quarter turn latch of FIG. 1.

FIG. 3 is a bottom plan view of the slotted arrow quarter turn latch of FIG. 1; and,

FIG. 4 is a right side view of the slotted arrow quarter turn latch of FIG. 1, the left side view being a mirror image thereof.

1 Claim, 4 Drawing Sheets

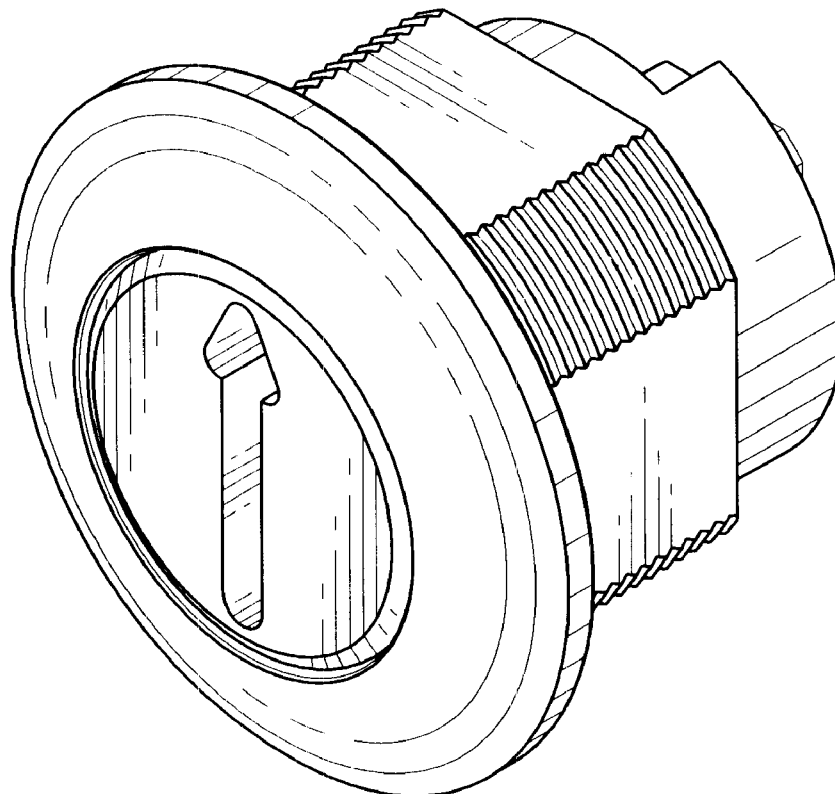

FIG. 1

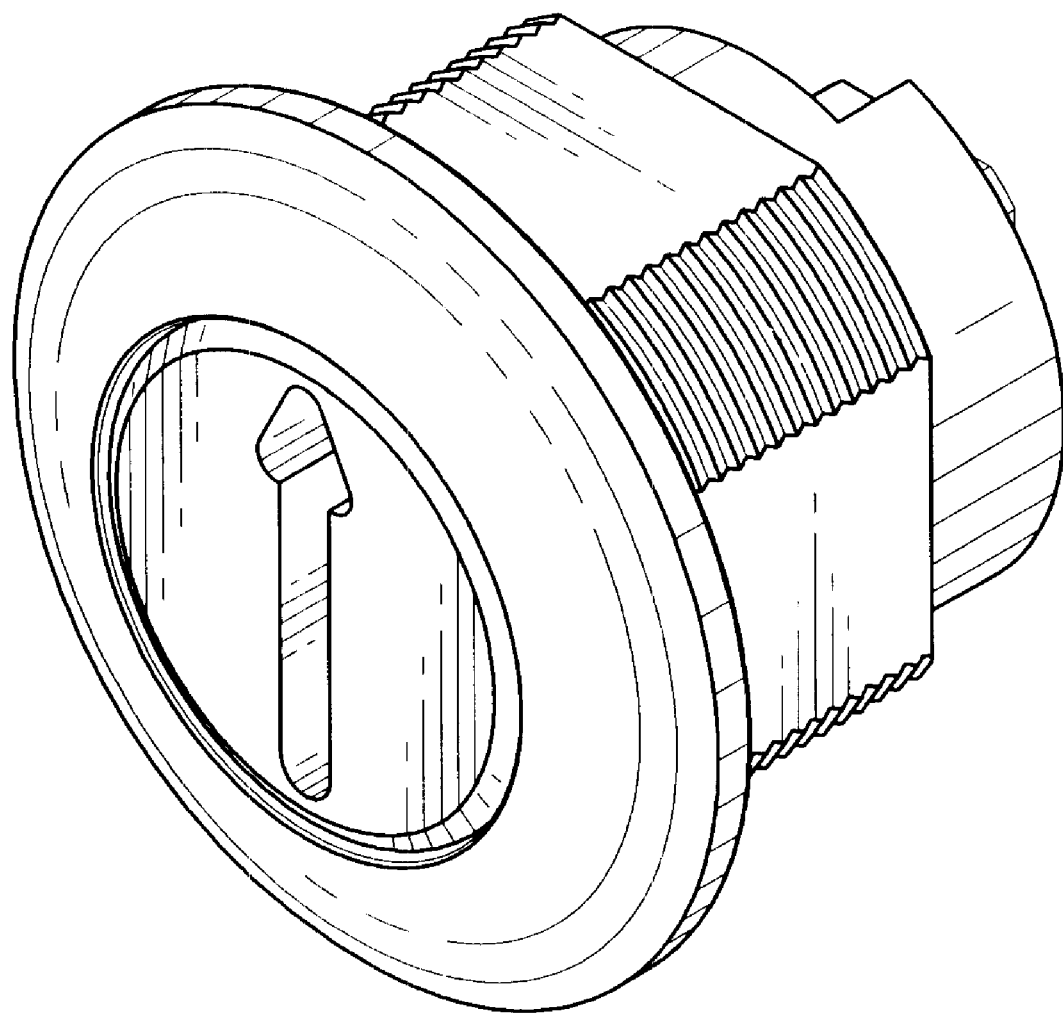

FIG. 2

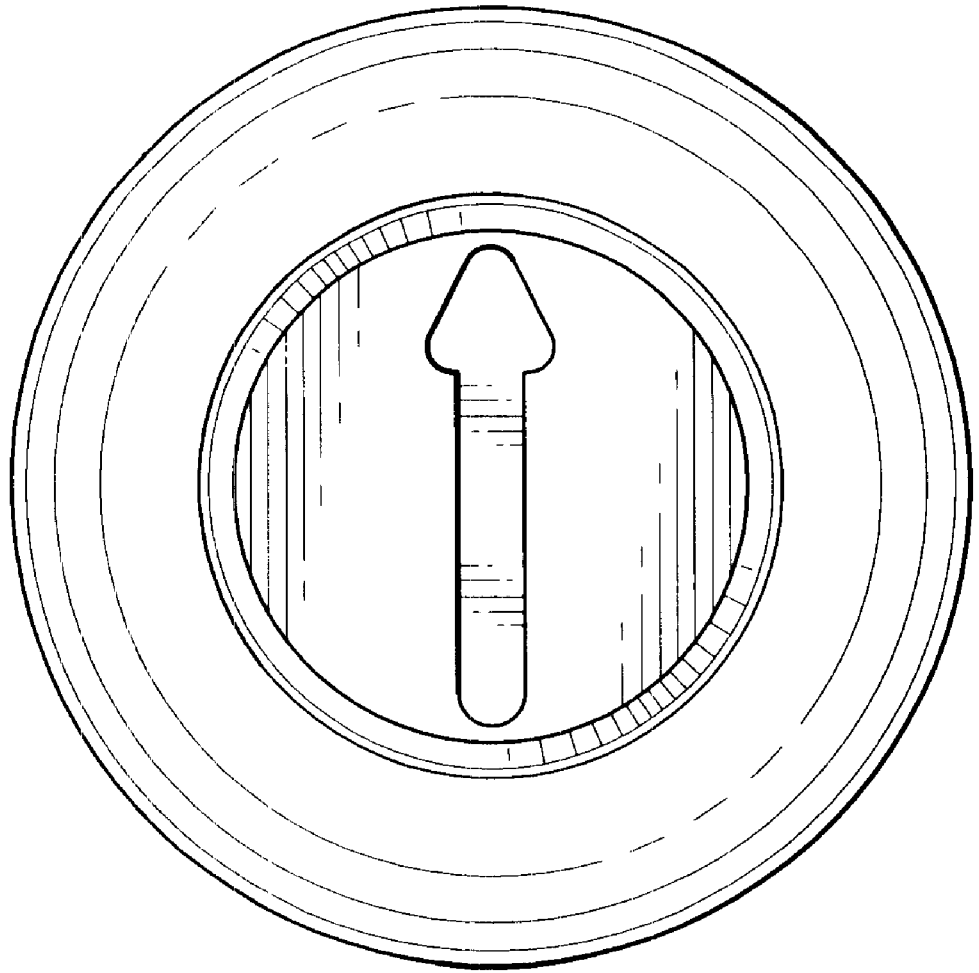

FIG. 3

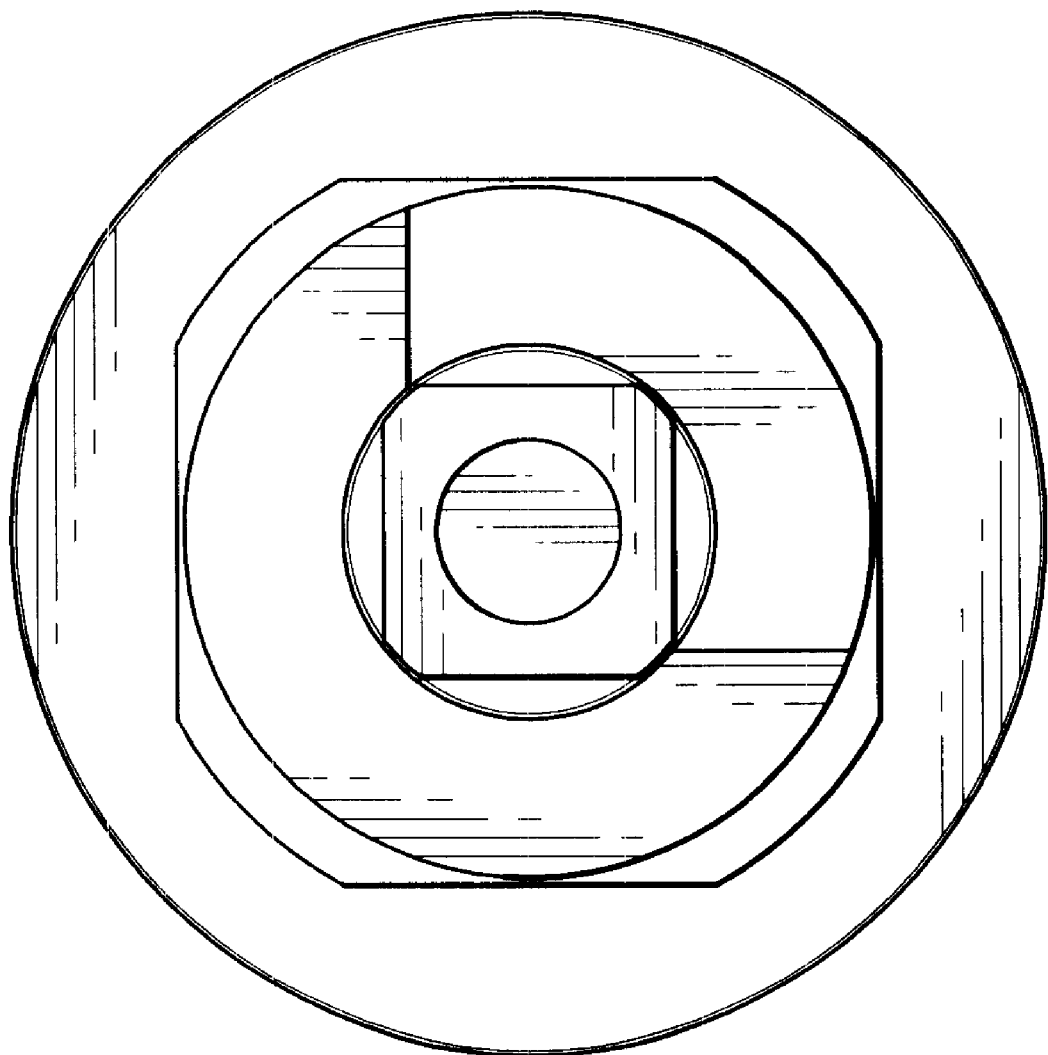
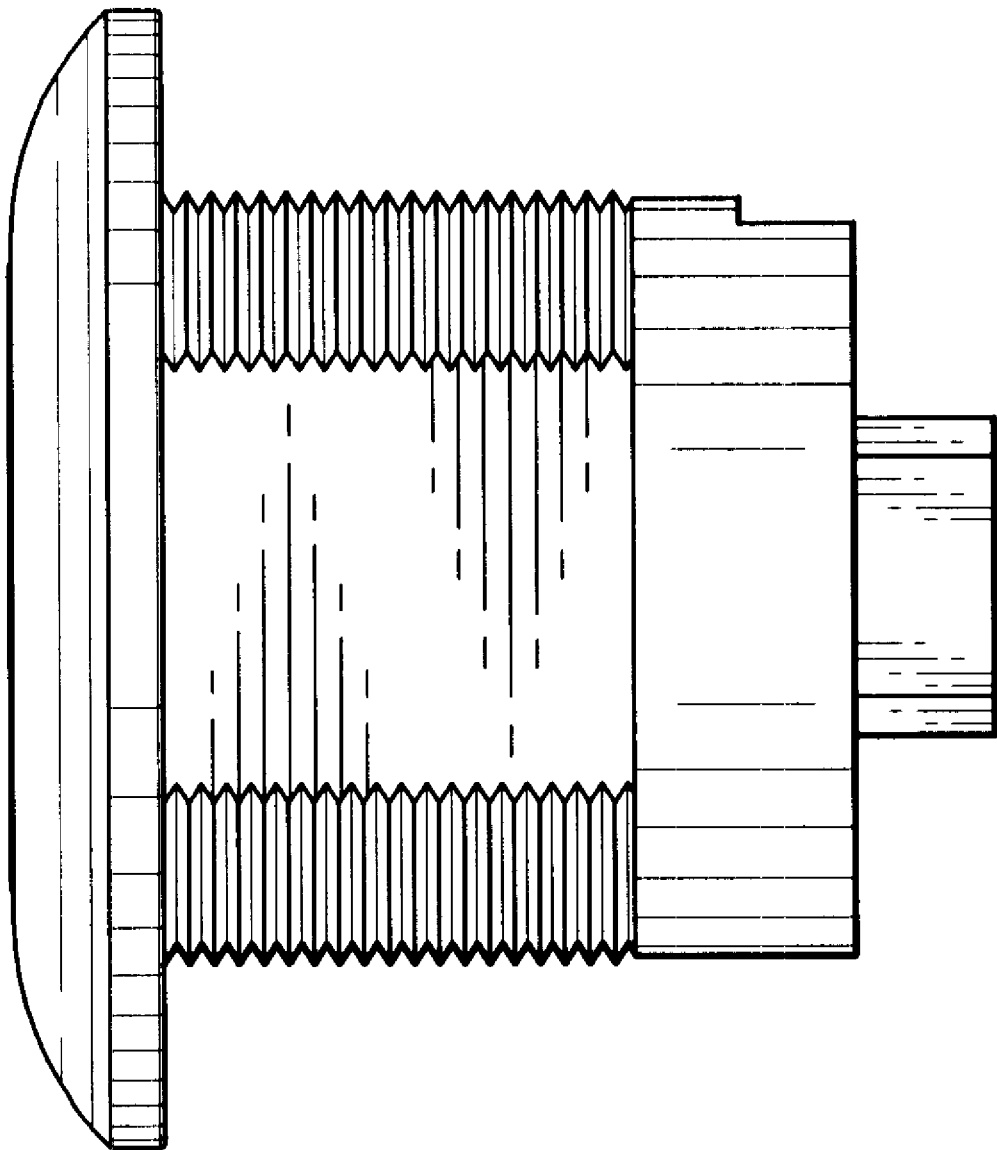

FIG. 4



ATTACHMENT B



**THERE'S ALWAYS
SOMETHING NEW
AT SIERRA PACIFIC**

**ISO 9001
CERTIFIED**

OVER 200 NEW PRODUCTS INSIDE

PAGES
26 - 45

PAGE
52

PAGES
85-95

PAGE
115

PAGES
97-98

QUARTER TURN LATCHES

QUARTER TURN LATCHES

- Cam rotates 90°
- Cam locators designed into inserts
- Intended for NEMA type 4, 4X & 12 enclosures
- Assembly includes:
 - Neoprene face gasket
 - Body nut
 - Cam retaining screw
 - Disc washer
 - (2) Internal o-rings
 - Available with UL rated seals (o-rings & face gasket)

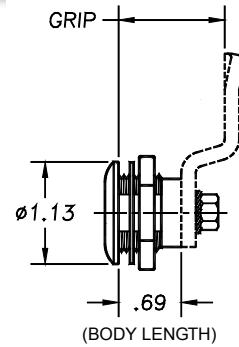

NOTE: Cams sold separately. See page 81 for cams & grip dimension

SLOTTED TURN LATCHES

| PART NUMBER | MATERIAL | | FINISH | |
|-------------|-----------------|-----------------|---------------------|---------------------|
| | HOUSING | PLUG | HOUSING | SLOTTED PLUG |
| 41-00 | Die cast zinc | Die cast zinc | Chrome plated | Chrome plated |
| 41-00BK | Die cast zinc | Die cast zinc | Black powder coated | Black powder coated |
| 41-00SS | Stainless steel | Stainless steel | Machine polished | Machine polished |
| 41BK-00 | Die Cast Zinc | Die Cast Zinc | Black powder coated | Chrome plated |
| 41-00P | Thermo-plastic* | Thermo-plastic* | Black textured | Black textured |
| 41P-00SS | Thermo-plastic* | Stainless steel | Black textured | Machine polished |

* Glass reinforced



Slotted Plug

HEX TURN LATCHES

| PART NUMBER | MATERIAL | | FINISH | |
|-------------|-----------------|-----------------|---------------------|---------------------|
| | HOUSING | PLUG | HOUSING | BELLCORE HEX PLUG |
| 41-04 | Die cast zinc | Die cast zinc | Chrome plated | Chrome plated |
| 41-04BK | Die cast zinc | Die cast zinc | Black powder coated | Black powder coated |
| 41-04SS | Stainless steel | Stainless steel | Machine polished | Machine polished |
| 41P-04SS | Thermo-plastic* | Stainless steel | Black textured | Machine polished |

* Glass reinforced

- Activated with a 7/16" socket



Bellcore Hex Plug

THUMB TURN LATCHES

| PART NUMBER | MATERIAL | | FINISH | |
|-------------|---------------|---------------|---------------------|---------------------|
| | HOUSING | PLUG | HOUSING | THUMB TURN PLUG |
| 41-05 | Die cast zinc | Die cast zinc | Chrome plated | Chrome plated |
| 41-05BK | Die cast zinc | Die cast zinc | Black powder coated | Black powder coated |



Thumb Turn Plug



**Innovative Design Solutions
To Your Specifications**

SIERRA PACIFIC ENGINEERING AND PRODUCTS

THREE LOCATIONS NATIONALLY

Los Angeles, CA
3144 E. Maria Street
Rancho Dominguez, CA 90221

Dallas, TX

Chicago, IL

Call Toll-free
800-433-5554

In California
(310) 608-0693

Fax
(310) 608-0952

Web site
www.spep.com

2004 CATALOG COVER



SIERRA PACIFIC
ENGINEERING AND PRODUCTS

HINGES AND INDUSTRIAL HARDWARE

SIERRA PACIFIC ENGINEERING AND PRODUCTS

HINGES AND INDUSTRIAL HARDWARE

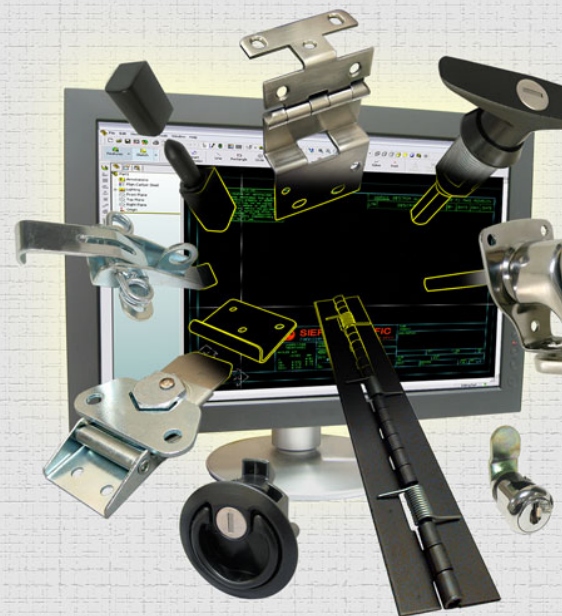

**ISO 9001:2000
CERTIFIED**

**Over
New Items**
See the Inside Cover

QUARTER TURN LATCHES

QUARTER TURN LATCHES

- Cam rotates 90°
- Cam locators designed into inserts
- Intended for NEMA type 4, 4X & 12 enclosures
- Assembly includes:
 - Body nut
 - Cam retaining screw
 - Disc washer
 - UL rated seals (o-ring & face gasket)

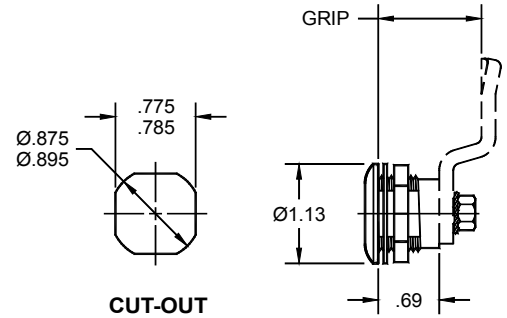

NOTE: Cams sold separately. See page 94 for cams & grip dimension

SLOTTED PLUG TURN LATCHES

| PART NUMBER | MATERIAL | | FINISH | |
|-------------|-----------------|-----------------|---------------------|---------------------|
| | HOUSING | PLUG | HOUSING | SLOTTED PLUG |
| 41-00 | Die cast zinc | Die cast zinc | Chrome plated | Chrome plated |
| 41-00BK | Die cast zinc | Die cast zinc | Black powder coated | Black powder coated |
| 41-00SS | Stainless steel | Stainless steel | Machine polished | Machine polished |
| 41BK-00 | Die Cast Zinc | Die Cast Zinc | Black powder coated | Chrome plated |
| 41-00P | Thermo-plastic* | Thermo-plastic* | Black textured | Black textured |
| 41P-00SS | Thermo-plastic* | Stainless steel | Black textured | Machine polished |



PATENTED

NOTE: * Thermo-plastic material is glass reinforced

10MM RECESSED HEX PLUG TURN LATCHES

| PART NUMBER | MATERIAL | | FINISH | |
|-------------|-----------------|---------------|---------------------|---------------------|
| | HOUSING | PLUG | HOUSING | BELLCORE HEX PLUG |
| 41-03 | Die cast zinc | Die cast zinc | Chrome plated | Chrome plated |
| 41-03BK | Die cast zinc | Die cast zinc | Black powder coated | Black powder coated |
| 41BK-03 | Die cast zinc | Die cast zinc | Black powder coated | Chrome plated |
| 41P-03 | Thermo-plastic* | Die cast zinc | Black textured | Chrome plated |

NEW



NOTE: * Thermo-plastic material is glass reinforced

HEX PLUG TURN LATCHES

| PART NUMBER | MATERIAL | | FINISH | |
|-------------|-----------------|-----------------|---------------------|---------------------|
| | HOUSING | PLUG | HOUSING | BELLCORE HEX PLUG |
| 41-04 | Die cast zinc | Die cast zinc | Chrome plated | Chrome plated |
| 41-04BK | Die cast zinc | Die cast zinc | Black powder coated | Black powder coated |
| 41-04SS | Stainless steel | Stainless steel | Machine polished | Machine polished |
| 41P-04SS | Thermo-plastic* | Stainless steel | Black textured | Machine polished |



- Activated with a 7/16" socket

NOTE: * Thermo-plastic material is glass reinforced

Locks





Innovative Design Solutions
To Your Specifications



SIERRA PACIFIC

ENGINEERING AND PRODUCTS

THREE LOCATIONS NATIONALLY

Los Angeles, CA
3144 E. Maria Street
Rancho Dominguez, CA 90221

Dallas, TX

Chicago, IL

Call Toll-free
800-433-5554

In California
(310) 608-0693

Fax
(310) 608-0952

Web site
www.spep.com



SIERRA PACIFIC
ENGINEERING AND PRODUCTS

HINGES AND INDUSTRIAL HARDWARE

SIERRA PACIFIC

ENGINEERING AND PRODUCTS

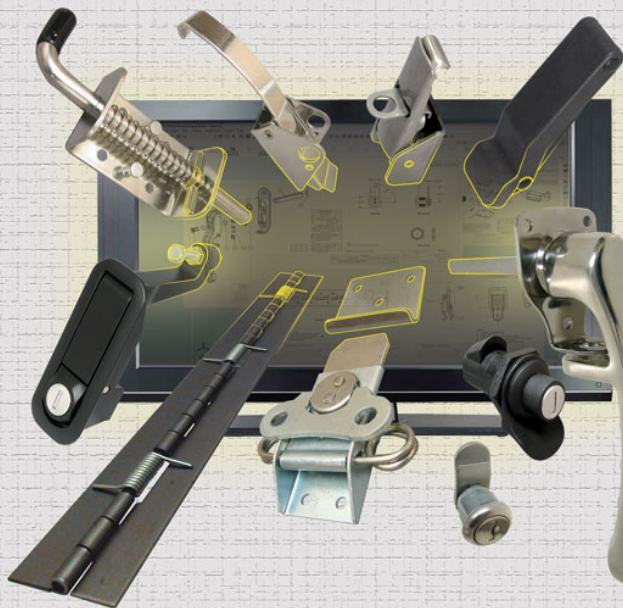

ESOP 100% **ISO 9001**
EMPLOYEE-OWNED **CERTIFIED**

**Over 300
New Items**
See the Inside Cover

HINGES AND INDUSTRIAL HARDWARE

QUARTER TURN LATCHES

QUARTER TURN LATCHES

- Cam rotates 90°
- Cam locators designed into inserts
- Intended for NEMA type 4, 4X & 12 enclosures
- Assembly includes:
 - Body nut
 - Cam retaining screw
 - Disc washer
 - UL rated seals (o-ring & face gasket)

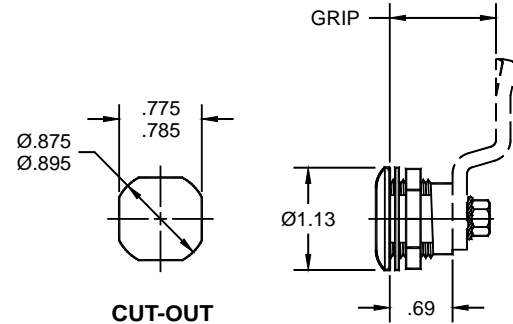

NOTE: Cams sold separately. See page 120 for cams & grip dimension

SLOTTED PLUG TURN LATCHES

| PART NUMBER | MATERIAL | | FINISH | |
|-------------|-----------------|-----------------|---------------------|---------------------|
| | HOUSING | PLUG | HOUSING | SLOTTED PLUG |
| 41-00 | Die cast zinc | Die cast zinc | Chrome plated | Chrome plated |
| 41-00BK | Die cast zinc | Die cast zinc | Matte black painted | Matte black painted |
| 41-00SS | Stainless steel | Stainless steel | Machine polished | Machine polished |
| 41BK-00 | Die Cast Zinc | Die Cast Zinc | Matte black painted | Chrome plated |
| 41-00P | Thermo-plastic | Thermo-plastic* | Black textured | Black textured |
| 41P-00SS | Thermo-plastic | Stainless steel | Black textured | Machine polished |



PATENTED

NOTE: * Thermo-plastic plug is glass reinforced

8MM RECESSED HEX PLUG TURN LATCHES

NEW
NEW

| PART NUMBER | MATERIAL | | FINISH | |
|-------------|---------------|---------------|---------------------|---------------------|
| | HOUSING | PLUG | HOUSING | BELLCORE HEX PLUG |
| 41-02 | Die cast zinc | Die cast zinc | Chrome plated | Chrome plated |
| 41-02BK | Die cast zinc | Die cast zinc | Matte black painted | Matte black painted |



10MM RECESSED HEX PLUG TURN LATCHES

| PART NUMBER | MATERIAL | | FINISH | |
|-------------|----------------|---------------|---------------------|---------------------|
| | HOUSING | PLUG | HOUSING | BELLCORE HEX PLUG |
| 41-03 | Die cast zinc | Die cast zinc | Chrome plated | Chrome plated |
| 41-03BK | Die cast zinc | Die cast zinc | Matte black painted | Matte black painted |
| 41BK-03 | Die cast zinc | Die cast zinc | Matte black painted | Chrome plated |
| 41P-03 | Thermo-plastic | Die cast zinc | Black textured | Chrome plated |



HEX PLUG TURN LATCHES

| PART NUMBER | MATERIAL | | FINISH | |
|-------------|-----------------|-----------------|---------------------|---------------------|
| | HOUSING | PLUG | HOUSING | BELLCORE HEX PLUG |
| 41-04 | Die cast zinc | Die cast zinc | Chrome plated | Chrome plated |
| 41-04BK | Die cast zinc | Die cast zinc | Matte black painted | Matte black painted |
| 41-04SS | Stainless steel | Stainless steel | Machine polished | Machine polished |
| 41P-04SS | Thermo-plastic | Stainless steel | Black textured | Machine polished |



- Activated with a 7/16" socket

QUARTER TURN LATCHES

QUARTER TURN LATCHES

- Cam rotates 90°
- Cam locators designed into inserts
- Intended for NEMA type 4, 4X & 12 enclosures
- Assembly includes:
 - Body nut
 - Cam retaining screw
 - Disc washer
 - UL rated seals (o-ring & face gasket)

NOTE: Cams sold separately. See page 124 for cams & grip dimension

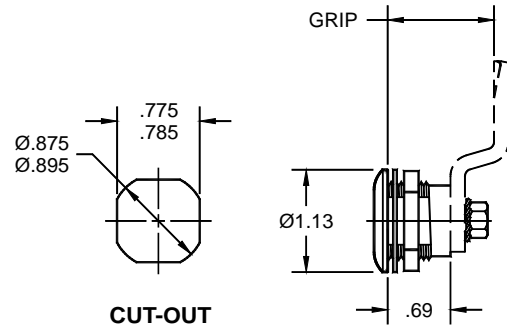

SLOTTED PLUG TURN LATCHES

| PART NUMBER | MATERIAL | | FINISH | |
|-------------|-----------------|-----------------|---------------------|---------------------|
| | HOUSING | PLUG | HOUSING | SLOTTED PLUG |
| 41-00 | Die cast zinc | Die cast zinc | Chrome plated | Chrome plated |
| 41-00BK | Die cast zinc | Die cast zinc | Matte black painted | Matte black painted |
| 41-00SS | Stainless steel | Stainless steel | Machine polished | Machine polished |
| 41BK-00 | Die Cast Zinc | Die Cast Zinc | Matte black painted | Chrome plated |
| 41-00P | Thermo-plastic | Thermo-plastic* | Black textured | Black textured |
| 41P-00SS | Thermo-plastic | Stainless steel | Black textured | Machine polished |

NOTE: * Thermo-plastic plug is glass reinforced



PATENTED

8MM RECESSED HEX PLUG TURN LATCHES

| PART NUMBER | MATERIAL | | FINISH | |
|-------------|---------------|---------------|---------------------|---------------------|
| | HOUSING | PLUG | HOUSING | BELLCORE HEX PLUG |
| 41-02 | Die cast zinc | Die cast zinc | Chrome plated | Chrome plated |
| 41-02BK | Die cast zinc | Die cast zinc | Matte black painted | Matte black painted |

- Hex tool key available separately as part no. 392-K (see page 103)



10MM RECESSED HEX PLUG TURN LATCHES

| PART NUMBER | MATERIAL | | FINISH | |
|-------------|----------------|---------------|---------------------|---------------------|
| | HOUSING | PLUG | HOUSING | BELLCORE HEX PLUG |
| 41-03 | Die cast zinc | Die cast zinc | Chrome plated | Chrome plated |
| 41-03BK | Die cast zinc | Die cast zinc | Matte black painted | Matte black painted |
| 41BK-03 | Die cast zinc | Die cast zinc | Matte black painted | Chrome plated |
| 41P-03 | Thermo-plastic | Die cast zinc | Black textured | Chrome plated |



HEX PLUG TURN LATCHES

| PART NUMBER | MATERIAL | | FINISH | |
|-------------|-----------------|-----------------|---------------------|---------------------|
| | HOUSING | PLUG | HOUSING | BELLCORE HEX PLUG |
| 41-04 | Die cast zinc | Die cast zinc | Chrome plated | Chrome plated |
| 41-04BK | Die cast zinc | Die cast zinc | Matte black painted | Matte black painted |
| 41-04SS | Stainless steel | Stainless steel | Machine polished | Machine polished |
| 41P-04SS | Thermo-plastic | Stainless steel | Black textured | Machine polished |

- Activated with a 7/16" socket



QUARTER TURN LATCHES

QUARTER TURN LATCHES

- Cam rotates 90°
- Cam locators designed into inserts
- Intended for NEMA type 4, 4X, 12 and IP66 enclosure requirements
- Assembly includes:
 - Body nut
 - Cam retaining screw
 - Disc washer
 - UL rated seals (o-ring & face gasket)

NOTE: Cams sold separately. See page 58 for cams & grip dimension

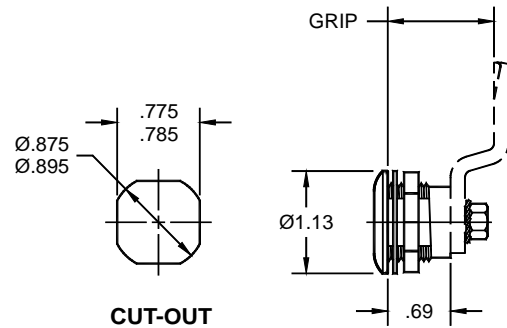

CUT-OUT

SLOTTED PLUG TURN LATCHES

| PART NUMBER | MATERIAL | | FINISH | |
|---------------------|-----------------|-----------------|---------------------|---------------------|
| | HOUSING | PLUG | HOUSING | SLOTTED PLUG |
| 41-00 | Die cast zinc | Die cast zinc | Chrome plated | Chrome plated |
| 41-00BK | Die cast zinc | Die cast zinc | Matte black painted | Matte black painted |
| 41-00SS | Stainless steel | Stainless steel | Machine polished | Machine polished |
| 41BK-00 | Die Cast Zinc | Die Cast Zinc | Matte black painted | Chrome plated |
| 41-00P | Thermo-plastic | Thermo-plastic* | Black textured | Black textured |
| 41P-00SS | Thermo-plastic | Stainless steel | Black textured | Machine polished |
| 41-00SST NEW | 316SS | 316SS | Passivated | Passivated |

NOTE: * Thermo-plastic plug is glass reinforced



PATENTED

8MM RECESSED HEX PLUG TURN LATCHES

| PART NUMBER | MATERIAL | | FINISH | |
|-------------|---------------|---------------|---------------------|---------------------|
| | HOUSING | PLUG | HOUSING | BELLCORE HEX PLUG |
| 41-02 | Die cast zinc | Die cast zinc | Chrome plated | Chrome plated |
| 41-02BK | Die cast zinc | Die cast zinc | Matte black painted | Matte black painted |

- Hex tool key available separately as part no. **392-K** (see page 23)



10MM RECESSED HEX PLUG TURN LATCHES

| PART NUMBER | MATERIAL | | FINISH | |
|-------------|----------------|---------------|---------------------|---------------------|
| | HOUSING | PLUG | HOUSING | BELLCORE HEX PLUG |
| 41-03 | Die cast zinc | Die cast zinc | Chrome plated | Chrome plated |
| 41-03BK | Die cast zinc | Die cast zinc | Matte black painted | Matte black painted |
| 41BK-03 | Die cast zinc | Die cast zinc | Matte black painted | Chrome plated |
| 41P-03 | Thermo-plastic | Die cast zinc | Black textured | Chrome plated |



HEX PLUG TURN LATCHES

| PART NUMBER | MATERIAL | | FINISH | |
|-------------|-----------------|-----------------|---------------------|---------------------|
| | HOUSING | PLUG | HOUSING | BELLCORE HEX PLUG |
| 41-04 | Die cast zinc | Die cast zinc | Chrome plated | Chrome plated |
| 41-04BK | Die cast zinc | Die cast zinc | Matte black painted | Matte black painted |
| 41-04SS | Stainless steel | Stainless steel | Machine polished | Machine polished |
| 41P-04SS | Thermo-plastic | Stainless steel | Black textured | Machine polished |

- Activated with a 7/16" socket



QUARTER TURN LATCHES

QUARTER-TURN LATCHES

- Cam rotates 90°
- Cam locators designed into inserts
- Intended for NEMA type 4, 4X, 12 and IP66 enclosure requirements
- Assembly includes:
 - Body nut
 - Cam retaining screw
 - Disc washer
 - UL rated seals (o-ring & face gasket)

NOTE: Cams sold separately. See page 67 for cams & grip dimension

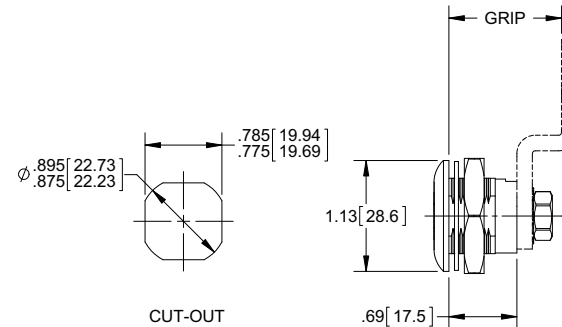

SLOTTED PLUG QUARTER-TURN LATCHES

| PART NUMBER | MATERIAL | | FINISH | |
|-------------|----------------|-----------------|---------------------|---------------------|
| | HOUSING | PLUG | HOUSING | SLOTTED PLUG |
| 41-00 | Die cast zinc | Die cast zinc | Chrome plated | Chrome plated |
| 41-00BK | Die cast zinc | Die cast zinc | Matte black painted | Matte black painted |
| 41-00SS | 304SS | 304SS | Machine polished | Machine polished |
| 41BK-00 | Die Cast Zinc | Die Cast Zinc | Matte black painted | Chrome plated |
| 41-00P | Thermo-plastic | Thermo-plastic* | Black textured | Black textured |
| 41P-00SS | Thermo-plastic | 304SS | Black textured | Machine polished |
| 41-00SST | 316SS | 316SS | Passivated | Passivated |

NOTE: * Thermo-plastic plug is glass reinforced

NOTE: Parts with thermo-plastic materials have UV stabilizers



PATENTED

8MM RECESSED HEX PLUG QUARTER-TURN LATCHES

| PART NUMBER | MATERIAL | | FINISH | |
|-------------|---------------|---------------|---------------------|---------------------|
| | HOUSING | PLUG | HOUSING | BELLCORE HEX PLUG |
| 41-02 | Die cast zinc | Die cast zinc | Chrome plated | Chrome plated |
| 41-02BK | Die cast zinc | Die cast zinc | Matte black painted | Matte black painted |

- Hex tool key available separately as part no. 392-K (see page 21)



10MM RECESSED HEX PLUG QUARTER-TURN LATCHES

| PART NUMBER | MATERIAL | | FINISH | |
|-------------|----------------|---------------|---------------------|---------------------|
| | HOUSING | PLUG | HOUSING | BELLCORE HEX PLUG |
| 41-03 | Die cast zinc | Die cast zinc | Chrome plated | Chrome plated |
| 41-03BK | Die cast zinc | Die cast zinc | Matte black painted | Matte black painted |
| 41BK-03 | Die cast zinc | Die cast zinc | Matte black painted | Chrome plated |
| 41P-03 | Thermo-plastic | Die cast zinc | Black textured | Chrome plated |

NOTE: Parts with thermo-plastic materials have UV stabilizers



HEX PLUG QUARTER-TURN LATCHES

| PART NUMBER | MATERIAL | | FINISH | |
|-------------|----------------|---------------|---------------------|---------------------|
| | HOUSING | PLUG | HOUSING | BELLCORE HEX PLUG |
| 41-04 | Die cast zinc | Die cast zinc | Chrome plated | Chrome plated |
| 41-04BK | Die cast zinc | Die cast zinc | Matte black painted | Matte black painted |
| 41-04SS | 304SS | 304SS | Machine polished | Machine polished |
| 41P-04SS | Thermo-plastic | 304SS | Black textured | Machine polished |

- Activated with a 7/16" socket

NOTE: Parts with thermo-plastic materials have UV stabilizers



Quarter-turn Latches

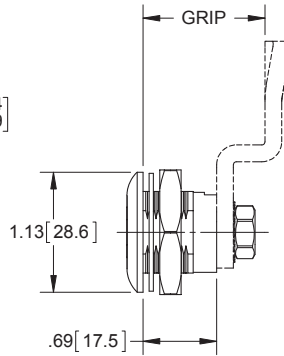
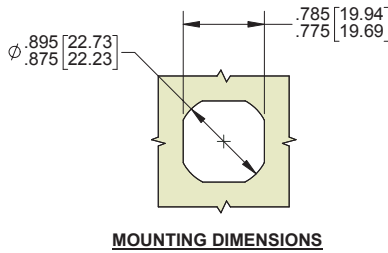

Features

- ▶ cam rotates 90°
- ▶ cam locators designed into inserts
- ▶ intended for NEMA type 4, 4X, 12 and IP66 enclosure requirements
- ▶ assembly includes:
 - ▶ body nut
 - ▶ cam retaining screw
 - ▶ disc washer
 - ▶ UL rated seals (o-ring & face gasket)
- ▶ cams sold separately. See pg. 95 for cams & grip dimension



Slotted Plug Quarter-turn Latches



patented

| Part Number | Material | | Finish | |
|-------------|---------------|----------------|---------------------|---------------------|
| | Housing | Slotted Plug | Housing | Slotted Plug |
| 41-00 | die cast zinc | die cast zinc | chrome plated | chrome plated |
| 41-00BK | die cast zinc | die cast zinc | matte black painted | matte black painted |
| 41-00SS | 304SS | 304SS | machine polished | machine polished |
| 41BK-00 | die cast zinc | die cast zinc | matte black painted | chrome plated |
| 41-00P | thermoplastic | thermoplastic* | black textured | black textured |
| 41P-00SS | thermoplastic | 304SS | black textured | machine polished |
| 41-00SST | 316SS | 316SS | passivated | passivated |

- ▶ * thermoplastic plug is glass reinforced
- ▶ parts with thermoplastic materials have UV stabilizers



8mm Recessed Hex Plug Quarter-turn Latches

| Part Number | Material | | Finish | |
|-------------|---------------|---------------|---------------------|---------------------|
| | Housing | Hex Plug | Housing | Hex Plug |
| 41-02 | die cast zinc | die cast zinc | chrome plated | chrome plated |
| 41-02BK | die cast zinc | die cast zinc | matte black painted | matte black painted |

- ▶ hex tool key sold separately as part no. 392-K pg. 31



10mm Recessed Hex Plug Quarter-turn Latches

| Part Number | Material | | Finish | |
|-------------|---------------|---------------|---------------------|---------------------|
| | Housing | Hex Plug | Housing | Hex Plug |
| 41-03 | die cast zinc | die cast zinc | chrome plated | chrome plated |
| 41-03BK | die cast zinc | die cast zinc | matte black painted | matte black painted |
| 41BK-03 | die cast zinc | die cast zinc | matte black painted | chrome plated |
| 41P-03 | thermoplastic | die cast zinc | black textured | chrome plated |

- ▶ parts with thermoplastic materials have UV stabilizers



Hex Plug Quarter-turn Latches

| Part Number | Material | | Finish | |
|-------------|---------------|-------------------|---------------------|---------------------|
| | Housing | Bellcore Hex Plug | Housing | Bellcore Hex Plug |
| 41-04 | die cast zinc | die cast zinc | chrome plated | chrome plated |
| 41-04BK | die cast zinc | die cast zinc | matte black painted | matte black painted |
| 41-04SS | 304SS | 304SS | machine polished | machine polished |
| 41P-04SS | thermoplastic | 304SS | black textured | machine polished |

- ▶ activated with a 7/16" socket
- ▶ parts with thermoplastic materials have UV stabilizers