

Quarter-turn Latches

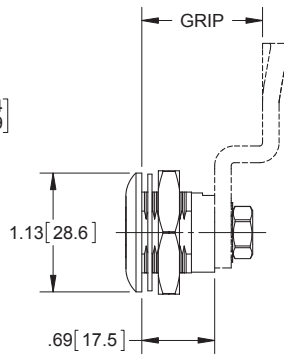

- Features**
- ▶ cam rotates 90°
  - ▶ cam locators designed into inserts
  - ▶ intended for NEMA type 4, 4X, 12 and IP66 enclosure requirements
  - ▶ assembly includes:
    - ▶ body nut
    - ▶ cam retaining screw
    - ▶ disc washer
    - ▶ UL rated seals (o-ring & face gasket)
  - ▶ cams sold separately. See pg. 95 for cams & grip dimension

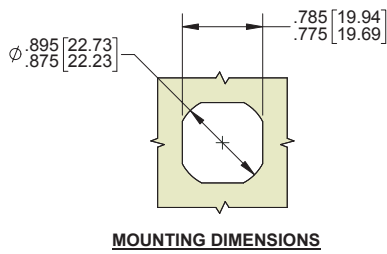

patented



**Slotted Plug Quarter-turn Latches**

Part Number	Material		Finish	
	Housing	Slotted Plug	Housing	Slotted Plug
41-00	die cast zinc	die cast zinc	chrome plated	chrome plated
41-00BK	die cast zinc	die cast zinc	matte black painted	matte black painted
41-00SS	304SS	304SS	machine polished	machine polished
41BK-00	die cast zinc	die cast zinc	matte black painted	chrome plated
41-00P	thermoplastic	thermoplastic*	black textured	black textured
41P-00SS	thermoplastic	304SS	black textured	machine polished
41-00SST	316SS	316SS	passivated	passivated

- ▶ \* thermoplastic plug is glass reinforced
- ▶ parts with thermoplastic materials have UV stabilizers



**8mm Recessed Hex Plug Quarter-turn Latches**

Part Number	Material		Finish	
	Housing	Hex Plug	Housing	Hex Plug
41-02	die cast zinc	die cast zinc	chrome plated	chrome plated
41-02BK	die cast zinc	die cast zinc	matte black painted	matte black painted

- ▶ hex tool key sold separately as part no. 392-K pg. 31



**10mm Recessed Hex Plug Quarter-turn Latches**

Part Number	Material		Finish	
	Housing	Hex Plug	Housing	Hex Plug
41-03	die cast zinc	die cast zinc	chrome plated	chrome plated
41-03BK	die cast zinc	die cast zinc	matte black painted	matte black painted
41BK-03	die cast zinc	die cast zinc	matte black painted	chrome plated
41P-03	thermoplastic	die cast zinc	black textured	chrome plated

- ▶ parts with thermoplastic materials have UV stabilizers



**Hex Plug Quarter-turn Latches**

Part Number	Material		Finish	
	Housing	Bellcore Hex Plug	Housing	Bellcore Hex Plug
41-04	die cast zinc	die cast zinc	chrome plated	chrome plated
41-04BK	die cast zinc	die cast zinc	matte black painted	matte black painted
41-04SS	304SS	304SS	machine polished	machine polished
41P-04SS	thermoplastic	304SS	black textured	machine polished

- ▶ activated with a 7/16" socket
- ▶ parts with thermoplastic materials have UV stabilizers