

COVID-19 Test Kit Instructions

! Please use caution when handling the sample collection tube. The contents are used to aid in sample stabilization, however they are hazardous. **DO NOT EAT OR DRINK CONTENTS!** It can cause skin and eye irritation. Use caution in handling this tube. Call poison control if you come in contact with this sample stabilization solution.

DO NOT HAVE...

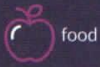

food



drinks



mouthwash



20 MINUTES
before the swab
collection

If you have trouble following the instructions, contact us: support@curativeinc.com

Open the bag, peel open the swab package and remove the swab. **Do not touch the swab or place swab on any surface area before or after sample collection.**

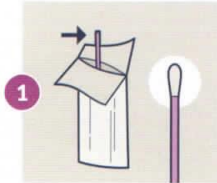

Hold the swab on its score line. **Cough deeply 3-5 times** and swish phlegm or spit around mouth. Then swab; **a. inside of each cheek b. upper and lower gums, c. underneath and top of tongue, d. roof of mouth.**

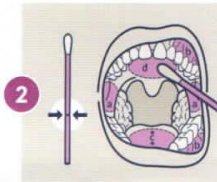

Uncap the lid of the tube and insert the swab with the saliva sample into the tube with the **swab side down. Do not spill or drink the liquid.** Carefully break the swab at the score line.

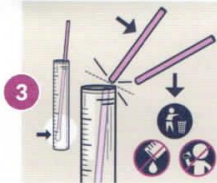

Securely cap the tube. **Turn it upside down several times to mix specimen with tube solution.**

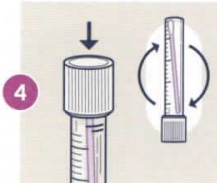

Put the tube back into the biohazard bag, ensure the absorbent pad is inside, and **seal the top of the bag.**

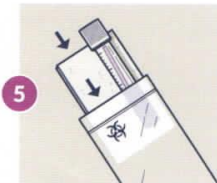

Return sample bag back to **sample collection facilitator.**

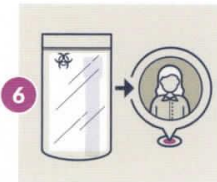

Let's get started.



FACILITATOR



Results will be available within **48 hours** of receipt of sample to the lab.