

SERIES 200 INSTALLATION INSTRUCTIONS

USE ASTA AMERICA PARTS ONLY - ALL OTHERS SHALL VOID WARRANTY

IMPORTANT REMARKS ALL ASTA PRODUCTS MUST BE INSTALLED BY A LICENSED, QUALIFIED PROFESSIONAL DOOR COMPANY TO QUALIFY FOR OUR WARRANTY. INSTALLATION WITHOUT PROPER TOOLS AND KNOWLEDGE CAN RESULT IN PERSONAL INJURY. THIS PAMPHLET IS DESIGNED TO ASSIST A PROFESSIONAL IN THE INSTALLATION OF ASTA 200 SERIES COMMERCIAL SHEET DOORS. SAFETY IS FOREMOST. INSTALLATION SHOULD BE EXECUTED BY LICENSED, QUALIFIED DOOR PROFESSIONALS. INSPECT ALL OF THE SHIPPED PARTS AND ACCOUNT FOR EVERYTHING BEFORE COMMENCING ANY WORK. FOR QUESTIONS AND TECHNICAL ASSISTANCE, CONTACT ASTA CUSTOMER SUPPORT AT (770) 974-2600.

WARNING

MOVING DOOR CAN CAUSE SERIOUS INJURY OR DEATH
KEEP CLEAR OF OPENING WHILE DOOR IS MOVING.



SAFETY INSTRUCTIONS

1. **DO NOT STAND OR WALK UNDER MOVING DOOR. KEEP DOOR IN FULL VIEW AND FREE OF OBSTRUCTION WHILE OPERATING.**
2. **DO NOT ALLOW CHILDREN TO OPERATE THE DOOR OR AUTOMATIC OPERATOR.**
3. **REPAIRS OR ADJUSTMENTS SHOULD BE MADE BY A TRAINED SERVICE PERSON USING PROPER TOOLS AND INSTRUCTIONS.**
4. **TO AVOID INJURY, DO NOT PUT FINGERS BETWEEN DOOR AND GUIDES.**
5. **READ OWNER'S MANUAL FOR YOUR DOOR AND OPERATOR FOR MORE INFORMATION.**

CAUTION: USE CORRECT LIFTING PROCEDURES AND EQUIPMENT DURING INSTALLATION OF THIS PRODUCT TO AVOID INJURY OR DAMAGE.

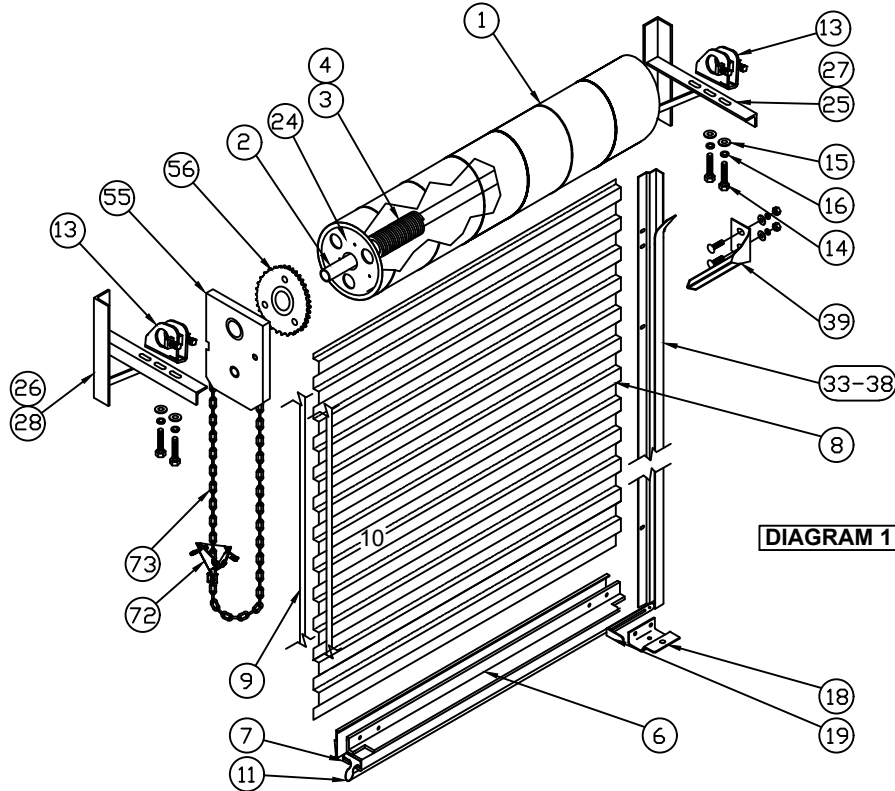

DIAGRAM 1

PARTS LIST

1	VARIABLES	SPRAL TUBE	34	VARIABLES	DOOR GUIDE, 14GA STANDARD - RH	66	420114-2	2000R-72 CHAIN HOIST ASSEMBLY:
2	VARIABLES	AXLE PIPE	35	VARIABLES	DOOR GUIDE, 12GA HEAVY DUTY - LH	67	440001-1	DRIVE SPROCKET, 41A72-9"
3	VARIABLES	SPRING - LEFT HAND	36	VARIABLES	DOOR GUIDE, 12GA HEAVY DUTY - RH	68	460698-1	ROLLER CHAIN, #41 x 4.6'
4	VARIABLES	SPRING - RIGHT HAND	37	VARIABLES	DOOR GUIDE, 12GA WINDLOCK - LH	ALL CHAIN HOIST INCLUDE ITEMS BELOW / E.O. KIT - FASTENERS ONLY:		
5	230003-1	SPRING CLAMP ASSEMBLY	38	VARIABLES	DOOR GUIDE, 12GA WINDLOCK - RH	69	420107-1	MASTER LINK, #41
6	VARIABLES	BOTTOM ANGLE	39	321105-0	REMOVABLE HEADSTOPS, PAIR	70	750203-1	LOCK WASHER, 3/8"
7	VARIABLES	ALUMINUM BOTTOM RETAINER	40	740206-1	FLAT HEAD PHILLIPS BOLT, 5/16" - 18 x 1"	71	730100-1	HEX HEAD BOLT, 3/8" - 16 x 1-1/2"
8	VARIABLES	CORRUGATED STEEL SHEET	41	740102-1	HEX NUT, 5/16" - 18	72	420300-2	HAND CHAIN RETAINER CLIP
9	260001-1	ELASTIC CURTAIN WEAR STRIP COMMERCIAL (FRONT SIDE)	42	750202-1	LOCK WASHER, 5/16"	73	420299-1	HAND CHAIN - OPEN LINK
10	260002-1	NYLON CURTAIN WEAR STRIP COMMERCIAL (BACK SIDE)	43	750102-1	FLAT WASHER, 5/16"	JAMB / WALL FASTENERS:		
11	260004-F	BULB ASTRAGAL, BOTTOM WEATHERSEAL	44	410103-1	NYLON ROPE, 3/16"	STEEL JAMB:		
12	420117-1	STHS, 1-5/16" TENSION AXLE SUPPORT (OPTIONAL)	45	310400-1	MOUNTING PLATES, 3/16" STANDARD - PAIR	74	730702-1	TEK SCREW, #14 x 3/4" (GUIDE)
13	420116-1	SAS, 1-5/16" STAMPED AXLE SUPPORT (NON-TENSION)	46	310410-1	MOUNTING PLATES, 1/4" HEAVY DUTY - PAIR	75	730703-1	TEK SCREW, #14 x 3/4" BUILD EX (GUIDE) - 203, 203IM & 204 ONLY
14	730804-1	BOLT, 3/8" - 16 x 3/4" HEX HEAD	MODELS 202, 202HD & 204 ONLY:			WOOD JAMBS:		
15	750103-1	FLAT WASHER, 3/8"	47	260303-1	INSULATION, DOUBLE FOIL	76	730403-1	WOOD LAG SCREW, 1/4" x 2" (GUIDE)
16	750203-1	LOCK WASHER, 3/8"	48	260402-1	MYLAR TAPE, 4"	77	730402-1	WOOD LAG SCREW, 3/8" x 2" (BRACKET)
17	740103-1	HEX NUT, 3/8" - 16	49	630002-1	TOP DRAFT STOP, 2-1/2" WIDE	MASONRY JAMBS:		
18	280301-1	DOOR STOP, LIFT CLIP	50	850204-1	7/8" RETAINER FOR JAMB BRUSH SEAL	78	760203-1	TAPCON SCREW, 1/4" x 1-3/4" (GUIDE-NO CLIPS)
19	280104-1	SLIDE BOLT LOCK	51	850211-1	2" JAMB BRUSH SEAL	79	760102-1	SLEEVE ANCHOR, 1/2" x 2-1/4" (GUIDE & BRACKET)
20	730301-1	CARRIAGE BOLT, 1/4" - 20 x 1"	MODELS 203 & 204 ONLY:			80	760104-1	SLEEVE ANCHOR, 1/2" x 3" (GUIDE & BRACKET) - 203IM ONLY
21	740201-1	SELF LOCKING NUT, 1/4" - 20	52	270501-1	WINDLOCK CLIP, COMMERCIAL	ADJUSTABLE BRACKETS SYSTEM		
22	750101-1	FLAT WASHER, 1/4"	53	720101-1	POP RIVET, 3/16"	81	310300-1TERM	ADJUSTABLE BRACKET - LH
23	740102-1	HEX NUT, 5/16" - 18	54	270502-1	WINDLOCK BACKER PLATE, COMMERCIAL	82	310300-2TERM	ADJUSTABLE BRACKET - RH
24	220300BB-1	12" DRUM ASSEMBLY w/ BEARING	55	420103-1	4:1 POCKET WHEEL CHAIN HOIST ASSEMBLY:	83	310450-1	ADJUSTABLE BRACKET PLATE
25	310200-1	STANDARD SUPPORT BRACKET, RH	56	420105-1	DRIVE SPROCKET, 41A40-3"	84	730604-1	5/16" - 18 X 1" FLAT HEAD SCREW
26	310300-1	STANDARD SUPPORT BRACKET, LH	57	460699-1	ROLLER CHAIN, #41 x 1.9"	85	750102-1	5/16" FLAT WASHER
27	310200-1HD	HEAVY DUTY SUPPORT BRACKET, RH	58	420104-1	8:1 POCKET WHEEL CHAIN HOIST ASSEMBLY:	86	750202-1	5/16" LOCK WASHER
28	310300-1HD	HEAVY DUTY SUPPORT BRACKET, LH	59	440001-1	DRIVE SPROCKET, 41A72-9"	87	740106-1	5/16" - 18 HEX NUT
29	310500-1	EXT. STANDARD SUPPORT BRACKET, RH	60	460700-1	ROLLER CHAIN, #41 x 3.2"	88	730109-1	1/2" - 13 X 1 1/4" HEX HEAD BOLT
30	310510-1	EXT. STANDARD SUPPORT BRACKET, LH	61	440007-1	ELECTRIC OPERATOR (EO) KIT-NOT INSTALLED:	89	750106-1	1/2" FLAT WASHER
31	310500-1HD	EXTENDED HD SUPPORT BRACKET, RH	62	440001-1	DRIVE SPROCKET, 41A72-9"	90	750108-1	1/2" LOCK WASHER
32	310510-1HD	EXTENDED HD SUPPORT BRACKET, LH	63	420114-1	2000R-40 CHAIN HOIST ASSEMBLY:	91	740105-1	1/2" - 13 HEX NUT
33	VARIABLES	DOOR GUIDE, 14GA STANDARD - LH	64	420105-1	DRIVE SPROCKET, 41A40-3"	92	321105-1	REMOVABLE HEADSTOP KIT, (CONTAINS A QTY OF 4 OF 6 REQUIRED FOR ITEM #S 4,5,6 & 7.)
			65	420111-1	ROLLER CHAIN, #41 x 3.9"			