

HYPR USER GUIDE

Getting Started

[How to Pair Your Smartphone](#)

[How to Log into Your Computer](#)

[Using Offline Mode](#)

Using Remote Lock

[Add and Manage Paired Devices](#)

[Web Login / SSO](#)

[Getting Started with Web Login & Single Sign-On](#)

[Using Device Manager for Web Login](#)

[Other](#)

[Security Keys](#)

[Remote Desktop Protocol](#)

[Learn More](#)

[Common Issues & FAQ](#)

[HYPR Knowledge Base](#)

Using Remote Lock

In this Section:

[What is Remote Lock?](#)

[How to Use Remote Lock on Windows Computers](#)

What is Remote Lock?

Do you forget to lock your computer? It's difficult to quickly secure your computer when you're physically far away from your workstation. Remote Lock enables you to lock your computer from anywhere using the HYPR app.

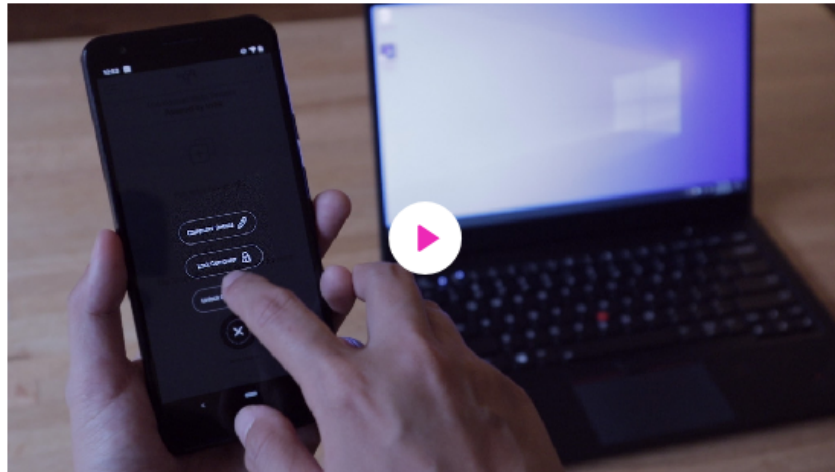

How to Use Remote Lock for Windows and MacOS Computers

In order to use Remote Lock, your computer and smartphone requires an

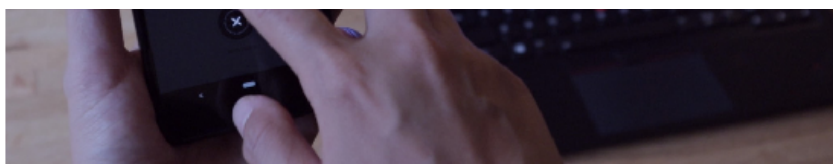

How to Use Remote Lock for Windows and MacOS Computers

In order to use Remote Lock, your computer and smartphone requires an internet connection.

1. Open the HYPR App on your smartphone



2. Tap and Hold your unlocked computer's icon

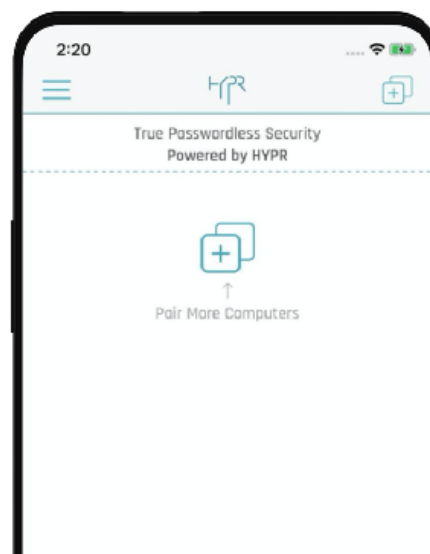

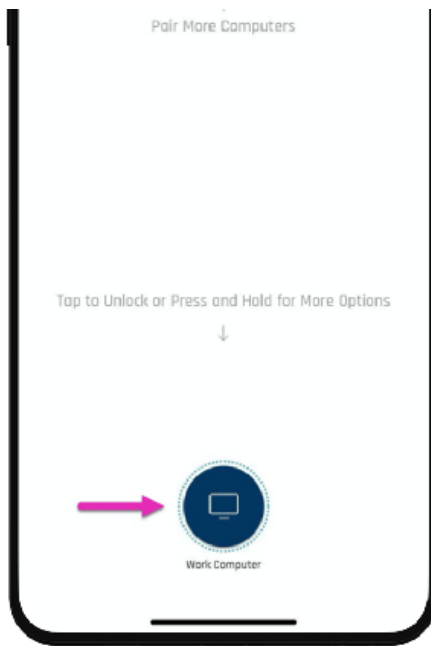

3. When the pop-up appears, select "Lock Computer"

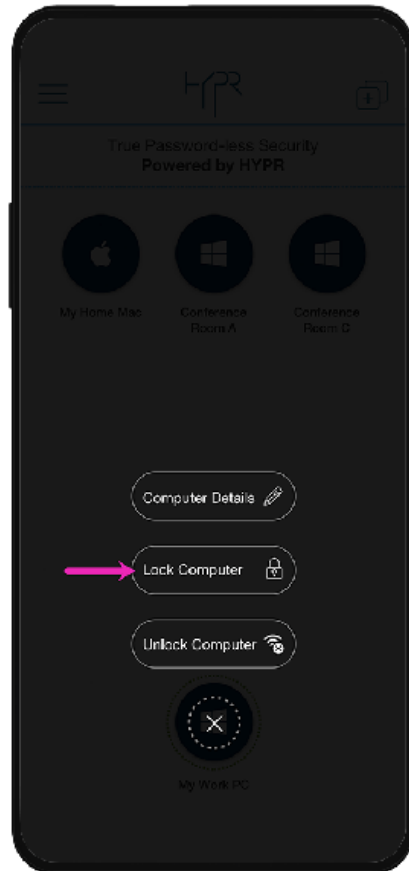

Have a Question?

[Check out our FAQ.](#)

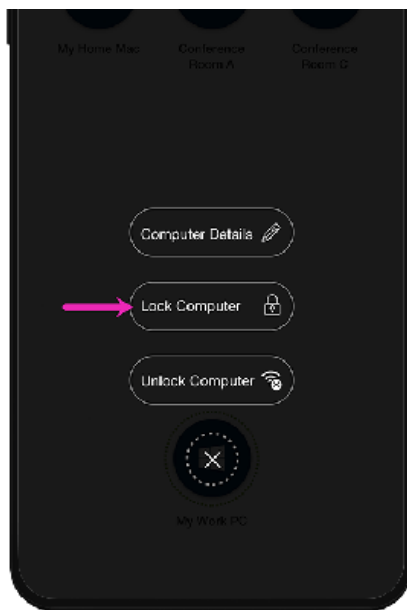

Have a Question?

[Check out our FAQ.](#)

Quick Links

- [Request Information](#)
- [Contact Us](#)
- [Partners](#)
- [Pricing](#)
- [Careers](#)
- [User Guide](#)
- [News Room](#)
- [Accessibility](#)
- [Platform](#)
- [Support](#)
- [Blog](#)
- [FAQ](#)
- [Sounds](#)

Solutions

- [True Passwordless MFA](#)
- [Passwordless Customer Authentication](#)
- [Passwordless Remote Login](#)
- [True Passwordless SSO](#)

Receive Updates and News from HYPR

Ready to Go Passwordless?

Get a free personalized demo and see for yourself how easy it is to eliminate passwords for your workforce and customers.



Copyright 2020 HYPR Corp

[Privacy Policy](#) | [Terms of Service](#) | [Legal](#)

