



30 DAY MONEY BACK GUARANTEE  
IF YOU'RE NOT BELIEVING IT!  
BIOWAVEGO

# BIOWAVEGO™

SMARTER PAIN BLOCKING TECHNOLOGY

Designed to Block Pain at the Source™

FDA CLEARED

STURGEON GENERAL'S OFFICE  
RECOMMENDS AND CLEMENSONS

MADE IN USA

**BIOWAVE YOUR PAIN AWAY**

Biowavego is a non-invasive, non-drug, non-toxic, and non-addictive device that uses advanced technology to block pain at the source. It is designed to be used for a wide range of pain conditions, including back pain, neck pain, and joint pain. Biowavego is the only device of its kind that has been cleared by the FDA and recommended by the Surgeon General's Office.

**Biowavego technology is used for:**

- Back pain
- Neck pain
- Joint pain
- Headaches
- Migraines
- Sciatica
- Arthritis
- Fibromyalgia
- Chronic pain
- Post-operative pain
- Menstrual pain
- Labor pain



# BIOWAVEGO

SMARTER PAIN BLOCKING TECHNOLOGY

## Quick Reference Guide

**DOWNLOAD** the  
BioWaveGO iOS or  
Android App on  
your smartphone  
for the best user  
experience.



## Controls & Supplies

### There are 3 buttons that control the device:

1. Power ON/OFF button
2. PLUS (+) button to increase intensity
3. MINUS (-) button to decrease intensity



### BioWave Pain Relief Pads

- BioWaveGO comes with three pairs of round 2" diameter Pain Relief Pads.
- Pain Relief Pads can typically be reused up to 10 times.
- BioWaveGO Pain Relief Pads can be reordered at [BioWave.com/reorderGOPADS](http://BioWave.com/reorderGOPADS)

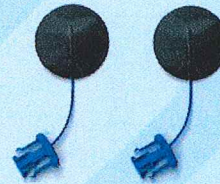

**Warning:** Pain Relief Pads must not touch each other when unit is turned on.

# Directions For Use

1. Clean your skin with a damp washcloth in the location the PAIN RELIEF PADS are to be placed.

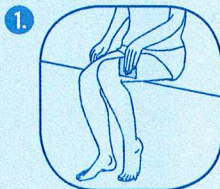

2. Plug Pain Relief Pad CONNECTORS into blue LEADWIRE CABLE CONNECTORS.

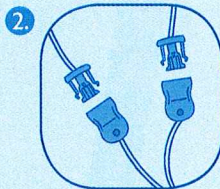

3. Apply Pain Relief Pads directly over areas of pain. See PAIN RELIEF PAD PLACEMENT PHOTOS on: [www.BioWave.com/GOtutorial](http://www.BioWave.com/GOtutorial)

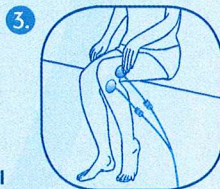

4. Plug LEADWIRE CABLE into RECEPTACLE so it clicks in place.



5. Press Power Button to turn unit on. LED Bar Graph will turn on. See Description of LED Bar Graph Indicator. Recommended: Launch mobile app and pair to the device.



6. Press the PLUS (+) button to start treatment. Continue to press the PLUS (+) button throughout the treatment so that a steady strong but comfortable tingling and pressure sensation is felt under the Pain Relief Pad(s) covering the pain site(s).

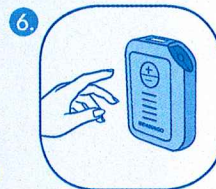

7. After use, recharge battery by plugging in AC CHARGER. Plug into RECEPTACLE and other end into a standard wall outlet to recharge the battery. Unit provides up to 6 treatments on a single charge.

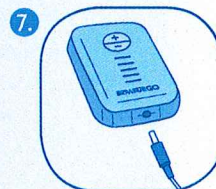

# LED Bar Graph Indicator

**The LED bar graph provides treatment information in different colors:**

- ◆ **Battery Strength Indicator - GREEN**  
Charging the Battery - GREEN
- ◆ **Blue Tooth Connection - BLUE**  
Signal Intensity - BLUE
- ◇ **Remaining Treatment Time - WHITE**  
Pause Treatment - WHITE
- ◆ **Troubleshooting - ORANGE**  
Please learn more at [BioWave.com/GOTutorial](http://BioWave.com/GOTutorial) or in the app.



# Using the Device

## Treatment Tips

- Make sure Pain Relief Pads are tacky and placed correctly on the body based on the Pain Relief Pad Placement Photos at [BioWave.com/GOtutorial](http://BioWave.com/GOtutorial).
- Users should increase the intensity to a level that is strong but still comfortable by pressing the PLUS (+) button
- Users should continue to press the PLUS (+) button throughout the 30-minute treatment to keep the sensation from the electrical field at a strong steady level.
- Research shows users should try to reach a minimum intensity level of 40% during the course of the treatment for the best effect. Some people may feel comfortable with more, some with less.

### Mobile App Control Alternative

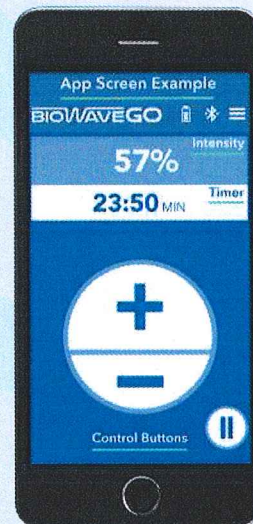

**INTENSITY NUMBER IS  
VIEWABLE ON THE APP**

# Pain Relief Pad Placement

Refer to [www.BioWave.com/GOtutorial](http://www.BioWave.com/GOtutorial) for more information on Pain Relief Pad Placement

BioWaveGO Pain Relief Pad placements are different from conventional electrical stimulation. The active electrical field forms beneath and surrounding each Pain Relief Pad. As a result, Pain Relief Pads need to be placed directly over specific locations of pain.

- 1. TWO LOCATIONS OF PAIN** - each pad can be placed directly over a painful area.
- 2. ONE LOCATION OF PAIN** - one pad is placed directly over a single location of pain; the second pad is placed over a bony area which is a comfortable location to receive stimulation.
- 3.** Pain Relief Pads must not touch each other when the unit is turned on.
- 4.** Pain Relief Pads are reusable but must be tacky to the touch. If not please use a new set of Pain Relief Pads.

## AREAS OF TREATMENT

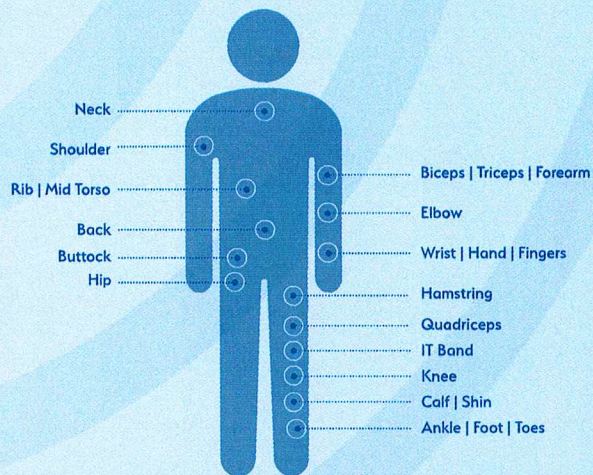

Refer to [www.BioWave.com/GOtutorial](http://www.BioWave.com/GOtutorial) for more information and a complete list of pain relief pad placement photos.

# Important

## **Contraindications – When Not to Use BioWaveGO**

- Do NOT place Pain Relief Pads over the heart, on the front or side of the neck, or on top of the head.
- Do NOT place Pain Relief Pads over open wounds, broken skin, rashy skin or sensitive skin areas like sunburned skin.
- Do NOT use BioWaveGO if you have an implanted cardiac pacemaker.

**NOTE:** BioWaveGO MAY BE USED over any location on the body that contains implanted metal hardware including total joint replacements, screws, pins, anchors or plates.

### **Pain Relief Pads Must Never Touch Each Other:**

- 1.0 inch is the minimum spacing between Pain Relief Pads.
- There is NO maximum spacing between Pain Relief Pads.

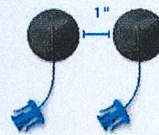

### **Questions?**

Call technical support:  
1-877-BIOWAVE ext 1  
(1-877-246-9283 ext 1)  
[BioWave.com/GOtutorial](http://BioWave.com/GOtutorial)



# BIOWAVEGO

SMARTER PAIN BLOCKING TECHNOLOGY

## Need help or to reorder Pain Relief Pads?

1-877-BIOWAVE x1 | [support@BioWave.com](mailto:support@BioWave.com) | [BioWave.com/reorderGOPADS](http://BioWave.com/reorderGOPADS)

The information, including but not limited to, text, graphics, images and other material contained herein are for informational purposes only. *Learn more at [BioWave.com/terms-of-use](http://BioWave.com/terms-of-use)*

Device must only be  
used with power  
supply provided.

Manufactured by  
BioWave Corporation  
Norwalk, CT  
©2018 BioWave Corporation

See User's Manual  
for more information:  
[www.BioWave.com/  
BioWaveGO-users-manual](http://www.BioWave.com/BioWaveGO-users-manual)

Rev 1 - 180723

MADE IN  
USA