

ofs

APTOS

Effective March 1, 2017



WARRANTY, TERMS & CONDITIONS	A-D
SHIPPING & ORDERING	A-D
FLAME RETARDANT INFORMATION	E
LOCK CORE ORDER FORM	F
COM & COL INFORMATION	G
FINISH OFFERING.	H
PRODUCT CARE.	I
QUICKSHIP.	J
ENVIRONMENTAL INFORMATION	K
PRODUCT REFERENCE MODIFICATION LIST	L
INTRODUCTION.	1
FREESTANDING DESKS, CREDENZAS AND RETURNS.	9
PEDESTALS19
WORKSURFACES, RUNOFFS AND SUPPORTS	34
ABOVE WORKSURFACE STORAGE AND ADD-ONS	55
LATERAL FILE DRAWER, TOWERS AND BOOKCASES	86
OPEN PLAN	95
ACCESSORIES AND ELECTRICAL.	116
INDEX BY MODEL NUMBER	127

WARRANTY

OFS casegoods and conference products are guaranteed to be free from defects in design, material and workmanship, given normal use and proper care, for 12 years of single-shift service with the exceptions noted below. OFS will repair or replace, at our discretion without charge to the original purchaser, any product or part thereof which fails as the result of such a defect during the warranty period. OFS assumes no responsibility for repairs to products that result from user modifications, attachments to a product, misuse, abuse, alteration or negligent use. Except as stated above, OFS makes no expressed or implied warranties as to any product, and, in particular, makes no warranty of merchantability or of fitness for any particular purpose. OFS shall not be liable for consequential or incidental damages arising from any product defect.

- All components not listed below **12 years**
- All drawer glide suspensions **Lifetime**
- All locking mechanisms **Lifetime**
- All door hinges **12 years**
- Door latches **12 years**
- Drawer pulls **12 years**
- Task lights **3 years**
- Casters/Pneumatic lifts **2 years**
- Foam padding **2 years**
- Base height adjustable mechanism **5 years**
- Electrical components/Power supplies **1 year**

This warranty does not cover:

- Damage caused by a transportation company.
- Natural variations in color, grain or texture of wood and other covering materials over which OFS has no control.
- Damage created by loading file drawers with anything other than hanging files.
- Conference tops attached to any other manufacturer's base.
- Fabric color matching, fabric puddling, fastness of colors or wearing qualities of any material.
- Freight or other shipping charges on returned product or parts, labor and service.

ORDERING INFORMATION

All orders should be placed with:

OFS
1204 East 6th St.
P.O. Box 100
Huntingburg, IN 47542
800-521-5381 Fax 812-683-7256
order_entry@ofsbrands.com

A customer drawing or sketch of the planned configuration in modular applications will facilitate order processing.

PRICES

All prices herein are list prices including delivery to one destination, effective with the date printed on the cover, and supersede all other published price lists. US List Prices are domestic prices only for shipment within the Continental United States. Prices are subject to change without notice, unless quoted in writing. Possession of the price list does not constitute authority to sell or offer for sale OFS products.

ACKNOWLEDGMENTS

Orders are acknowledged upon receipt of credit approval. Your acknowledgment is a detailed description of items, prices, shipping information and shipping date. Please read your acknowledgment closely and notify OFS immediately of any discrepancies. OFS is not responsible for errors on orders placed by phone without written confirmation.

AVAILABILITY

OFS is committed to the fastest possible shipment of all products. All other items are available within our normal manufacturing schedule. For information on stock availability, call our customer service hotline 800-521-5381.

Note: Planned shipping dates may be delayed due to fires, strikes, natural disasters or other causes beyond our control.

QUANTITY ORDERS

Contact your OFS Customer Service Representative to verify inventory and production schedules to ensure requested shipment date prior to placing large quantity orders.

DELIVERY AND FREIGHT CHARGES

All shipments are F.O.B. point of shipment, freight prepaid and allowed, excluding fuel surcharges. Shipments outside of the Continental United States are freight prepaid and allowed to port of exit. OFS reserves the right to select the most appropriate carrier and routing on all shipments; however, we will try to accommodate requests for your preferred carrier. OFS reserves the right to implement a fuel surcharge. Orders of less than \$1500 net will be assessed a handling charge of \$100 net per order. Any charges arising from failure to receive a shipment, rerouting while in transit or carrier storage charges are not included in prices shown. Orders requiring special services are subject to an additional charge.

These services include:

- Reconsignment from original destination to new destination **\$35 plus \$3.00 per mile net**
- Refused/Returned Freight
 - Freight refused at destination and returned to OFS **Double Freight**
 - Freight refused at time of delivery; returned to OFS to deliver at a later date **Triple Freight**
- Detention Fees (after 2 hours of waiting) **\$85 net per hour**
- Weekend delivery available Friday after 3:00 p.m. through Sunday night or Holiday **\$600 net per truck**
- Customer Pickup
 - Customer Request for 3rd party to pick up freight at OFS terminal **\$125 net**
- Change of Tags/Address/Phone #'s on Shipments **\$35 net**

SPECIAL ORDERS

The OFS line of office furniture is among the most complete in the industry. However, should a particular need arise requiring size modification or customization, contact your Customer Service Representative for a price quotation. Because of the uniqueness of the product, special orders are not subject to cancellation.

CANCELLATION AND ORDER CHANGES

All orders accepted by OFS are considered firm and binding and are not subject to cancellation.

WAREHOUSE STORAGE CHARGES

If a shipment is held beyond fourteen (14) calendar days after the order is ready for shipment at your request, a .067% per day (2% per month) storage charge will be assessed. The effective date will be fourteen (14) calendar days after the order is ready for shipment, as long as this date is after the acknowledged ship date. Further, the prices applied to the order will be those prices in effect at time of shipment.

EXTENDED PRODUCTION AND SHIP DATES

Orders placed with OFS with extended lead times as requested by you will be subject to price in effect at time of shipment.

DAMAGED MERCHANDISE AND FREIGHT CLAIMS

1. Inspect all cartons for damage and carton quantity. All shipments are delivered to the transportation company in good condition; OFS's liability ceases at this time. Do not refuse merchandise damaged in transit. Instead, enter a claim with the transportation company.

-
- Record damages and/or shortages on the bill of lading and freight bill. Do not accept the shipment until all shortages are noted on both the bill of lading and the freight bill. Sign only for the items you receive. If you give the delivering carrier a clear receipt for a shipment, the carrier is relieved of further responsibility.
 - If concealed damage is found: Notify the delivering carrier at once and request an inspection. For shipments via Styleline Logistics, notify your OFS Customer Service Representative. This must be done within fifteen (15) calendar days of delivery. Without this inspection the transportation company will not entertain a claim for loss or damage. If the carrier will not perform the inspection, you should prepare an affidavit that you contacted the carrier, noting the time and date, and that the carrier failed to comply with your request. All shipping cartons and inner packing must be retained for carrier inspection. Do not move the damaged merchandise from the receiving location. It must also be retained for the inspection.

RETURN OF MERCHANDISE

OFS will not accept returned merchandise without a signed Return Authorization (RA) issued by our Customer Service Department. All returned merchandise must be properly packaged and cartoned to prevent further damage. Carton must be clearly marked with identifying RA number so that proper credit can be issued. We will consider issuing RAs for the following reasons:

- Manufacturing defect (must be inspected by a OFS Sales Representative)
- OFS order processing error
- Shipping error
- Duplicate shipments
- Mismarked cartons

All merchandise must be returned within thirty (30) days of the date of the RA to receive credit. Freight damage, signs of usage, missing parts, etc. will be adjusted on the amount of credit to be issued.

REPAIR CHARGES

Reimbursement from OFS for repairs must have prior approval.

FINISH



The patented Euroluxe® finish is a chemically re-engineered Urethane clear coat that preserves the beautiful depth and clarity of OFS Brands' finishes, but allows for much greater performance with chemical and scratch resistance, as well as the complete elimination of dangerous formaldehyde emissions. The Euroluxe™ finish system achieves indoor air quality standards set by LEED and BIFMA furniture emission standards and allows all products to achieve SCS Global Services' Indoor Advantage Gold Certification. SilverBan® technology is an antimicrobial utilizing silver ions infused into the Euroluxe® wood finish for antimicrobial protection on all exposed wood surfaces. SilverBan® inhibits the growth of mold, mildew, fungus and bacteria on wood surfaces, as well as odors caused by bacterial growth, by 99.99%.

CUSTOM FINISH COLOR

Custom finish matching is available for special requirements. OFS must be provided with a suitable 8" x 10" or larger finish sample. However, custom finishes can be developed to meet specific needs. There will be a \$300 net upcharge per order for new custom finishes (waived on projects of \$100,000 net price or more). Custom finish upcharge for repeat or additional orders will be \$150 per order, even when the upcharge was waived on the original project. Custom finish matches are valid for 12 months from sample date. After this time period, custom finishes must be rematched and reapproved for use.

FINISH DISCLAIMER

Some desktop accessories with plastic feet can penetrate or burn the finish. This is not a defect in the finish. Wood is a natural product and minor variations in wood color, grain and texture may be visible even though the pieces are finished at the same time. Also, light finishes when exposed to ultraviolet rays may darken and change color. These are not defects in finish, and merchandise cannot be replaced because of these natural variations.

BIFMA AND ANSI TESTING

OFS is a member of the Business and Institutional Furniture Manufacturer's Association. Tests developed by BIFMA and approved by the American National Standards Institute (ANSI) determine the strength and durability of casegoods and seating in its everyday use. Although this testing does not serve as a warranty or guarantee, OFS products within this price list generally meet or exceed applicable BIFMA and ANSI standards.

MODIFICATION PRICING

Modifications must be clearly designated on customer's purchase order by placing the letters MOD and modification # in front of the model number and noting the modification needed.

Example: MOD#2-34-10824MCT-B5A-BUW-G1-G1 with top cut down to 104" wide

Contact your Customer Service Representative for upcharge on drawer configuration changes for traditional casegoods series.

TACKBOARD FABRICS

A complete list of fabrics that have been tested for tackboard application can be accessed at www.ofs.com > Materials > select a Textile Card and hover over swatch color. A window will open displaying tackboard availability. If your selected fabric is not on the list, please contact your Customer Service Representative for approval.

LOCKING INFORMATION

Factory Installed Locks are always keyed alike with key number 345T.

SPECIFIC KEY OPTIONS

Requirements for specific key options by office must be specified on the purchase order at the time the order is placed. Model Numbers with specific key options will specify "NO LOCK CORE" on the acknowledgment. A separate line item will be listed on the acknowledgment as "LOCK CORE SET." Specific lock cores and keys will be sent separately (see Field Installation below).

KEYLESS CABINET LOCKING SYSTEM

Keyless cabinet locking system uses radio frequency technology. One transmitter pad can operate single or multiple receiver latches. The locking system operates with separate and programmable user and supervisor codes. Optional modes are available for manual locking, self locking or single use locking of drawers and doors. Please contact your Customer Service Representative for applicability and for a price quotation.

FIELD INSTALLATION

Blank lock cores are installed at factory, allowing specific lock numbers to be ordered but shipped in a separate package for field installation. Lock Core Order Form (see page F) must be filled out and submitted with the purchase order. Lock core/key numbers 100 through 150 are available.

For quantity of locks per unit, please visit www.ofs.com and select Resources > Forms & Guides > Lock Core Guide.

RE-KEYING IN THE FIELD

Lock cores and keys can be purchased separately. The purchase order must specify quantity, key number(s) and color of the core (available in nickel, brass or black). Key numbers above number 150 are not stocked and may require a 3-week lead time. Orders ship standard UPS ground. Please note: A lock core change tool must be ordered for lock cores that will be re-keyed in the field.

ITEM

Lock Core and Key **\$19 list**
Lock Core Change Tool **\$29 list**
Master Key **\$29 list**

ALL ITEMS ARE NON-RETURNABLE.

FIRE RETARDANT PRODUCTS

FIRE RETARDANT PRODUCTS

California Technical Bulletin 117-2013: All OFS upholstered seating products and the resilient filling materials used in the upholstered seating products meet or exceed the requirements of the State of California, Department of Consumer Affairs, Technical Bulletin 117-2013. Compliance with these requirements is indicated by the label attached to the seat bottom.

Flame Retardant Chemicals: All standard OFS upholstered seating products are offered with components, as identified in TB117-2013, that are free of flame retardant chemicals. All OFS upholstered seating products will indicate Flame Retardant chemical composition in accordance to the labeling requirements of California Senate Bill 1019.

California Technical Bulletin 133: Cal TB 133 is a flammability test for seating products used in public spaces. The testing procedure for Cal TB 133 requires the burning of an entire product since the test is a composite test and not a component test. OFS has pretested and certified many different chair styles and upholsteries. If Cal TB 133 certification is required, a burn test may need to be completed with a specific model and upholstery combination. Contact Customer Service for Cal TB 133 approval, pricing and lead times.

OFS can not be held liable if purchase order does not indicate a requirement for Cal TB 133 compliance.

Boston Fire Code: Please contact OFS Customer Service if compliance is required.

LOCK CORE ORDER FORM

OFS BRANDS | LOCK CORE ORDER FORM

**FORM
DETAILS**

If this lock core order form is not submitted with the purchase order, all units will be keyed 345T.
Please note, each lock ordered consists of one (1) core and one (1) key.

Please indicate the brand to which this order applies. If ordering for multiple brands, please use a different form for each brand.

Lock cores are available in **NICKEL [N]**, **BRASS [BR]** or **BLACK [K]**. Key numbers **100-150 are in stock** and available for shipment with the purchase order. Other key numbers will be ordered, acknowledged and shipped on a separate order with a three (3) week delivery.

ORDER INFORMATION

Please print legibly and fill out every applicable field below.

DATE (MM/DD/YYYY)		SUBMITTED BY	
DEALER NAME		END USER NAME	
PURCHASE ORDER NUMBER		ACKNOWLEDGMENT NUMBER	
COMMENTS			

BRAND

Please circle the brand to which this order applies.

OFS

FIRSTOFFICE

CAROLINA

ORDER

Please continue on additional pages if needed. Mark the page number here.

PAGE NUMBER

TOTAL PAGES

QUANTITY	KEY NUMBER	COLOR	TAG
		[N] [BR] [K]	
		[N] [BR] [K]	
		[N] [BR] [K]	
		[N] [BR] [K]	
		[N] [BR] [K]	
		[N] [BR] [K]	
		[N] [BR] [K]	
		[N] [BR] [K]	
		[N] [BR] [K]	
		[N] [BR] [K]	
		[N] [BR] [K]	
		[N] [BR] [K]	
		[N] [BR] [K]	
		[N] [BR] [K]	
		[N] [BR] [K]	
		[N] [BR] [K]	
		[N] [BR] [K]	
		[N] [BR] [K]	
		[N] [BR] [K]	
		[N] [BR] [K]	
		[N] [BR] [K]	
		[N] [BR] [K]	

ALL STANDARD EUROLUXE® VENEERS

CHERRY

- LIGHT CHERRY [MLC]
Quartered or Flat Grain Pattern
- MOCHA CHERRY [MMC]
Quartered or Flat Grain Pattern
- QUARTERED ESPRESSO CHERRY [QEC]
Quartered Grain Pattern

WALNUT

- BURNISHED [BUW]
Quartered or Flat Grain Pattern
- DESERT [DST]
Quartered Grain Pattern
- DUSK [DSK]
Quartered Grain Pattern
- EBONY [EBY]
Quartered or Flat Grain Pattern
- ENGLISH WALNUT [MGW]
Quartered Grain Pattern
- NATURAL WALNUT [MNW]
Quartered Grain Pattern
- SABLE WALNUT [MSW]
Quartered or Flat Grain Pattern
- VINTAGE MAHOGANY / WALNUT [MVW]
Quartered or Flat Grain Pattern

MAPLE

- BLONDE MAPLE [MBM]
Quartered or Flat Grain Pattern
- HONEY MAPLE [MHM]
Quartered or Flat Grain Pattern

OAK

- CLEAR OAK [MRO]
Quartered Grain Pattern
- ESPRESSO OAK [MSO]
Quartered Grain Pattern
- OSLO [OSL]
Quartered Grain Pattern
- PECAN [PCO]
Quartered Grain Pattern
- STEEL GREY OAK [MGO]
Quartered Grain Pattern

STUDIO VENEERS (10%)

- SILVER GREY OAK [SVC]
Quartered Grain Pattern
- LINEA AMERICAN WALNUT [C2Q]
Quartered Grain Pattern
- LINEA SILVER BIRCH [C2P]
Quartered Grain Pattern

SOLID SURFACE

- CAMEO WHITE [CWS]
- CONCRETE [CSS]
- DEEP MINK [DMS]
- MODERN WHITE [MWS]

FABRIC PARTNERS

- ARC-COM
www.arc-com.com
- ARCHITEX
www.architex-ljh.com
- CAMIRA
www.camirafabrics.com
- CARNEGIE
www.carnegiefabrics.com
- DESIGNTEX
www.designtex.com
- GREEN HIDES
www.greenhides.com
- HELVETIA LEATHER
www.helvetialeather.com
- MAHARAM
www.maharam.com
- MAYER FABRICS
www.mayerfabrics.com
- MOMENTUM
www.themomgroup.com
- STINSON
www.cfstinson.com
- ULTRAFABRICS
www.ultrafabricsllc.com

PRODUCT CARE GUIDE

WOOD CARE

Careful craftsmanship combined with our Euroluxe finish makes your new OFS wood furniture incredibly durable, and with proper care your furniture will provide beauty and convenience for years.

All OFS products undergo rigid color-match procedures to ensure the best in color consistency.

- Dust frequently using a soft, damp, clean cloth, wiping with the grain.
- Remove liquid spills immediately, using a blotting rather than wiping motion.
- To clean, use a glass cleaner formulated with ammonia. Apply a small amount to a soft dry cloth and wipe in the direction of the grain. Dry with a soft cloth. Do not use furniture polish containing oil or silicone.
- Avoid prolonged exposure to direct sunlight, high humidity, extreme heat or cold and moisture.

LAMINATE CARE

- Avoid prolonged exposure to direct sunlight, high humidity, extreme heat or cold and moisture.
- Dust frequently with a soft, damp, clean cloth or mild detergent solution. Avoid using chemical or abrasive cleaning compounds.
- To avoid build up of cleaning agents, rinse the laminate surface with warm water and wipe with a clean damp cloth.

SEATING CARE

- Dust exposed wood parts frequently using a soft, damp, clean cloth, wiping with the grain.
- To clean wood, use a glass cleaner formulated with ammonia. Apply a small amount to a soft dry cloth and wipe in the direction of the grain. Dry with a soft cloth. Do not use furniture polish containing oil or silicone.
- To clean leather and vinyl upholstery, use a warm, damp cloth to restore a bright finish. For stubborn stains, use a moisturizing soap. Remove lather with a damp cloth, but do not rinse. Buff with a dry cloth.
- For fabric upholstery, use a damp cloth to wipe up spills. For tougher stains, contact your local OFS dealer for cleaning instructions.
- Avoid prolonged exposure to direct sunlight, high humidity, extreme heat or cold and moisture.
- The components of your OFS chair, such as controls, casters and understructure, require “common sense” care and cleaning as necessary.
- Activate chair mechanisms periodically to ensure proper function of moving parts.

PLEASE REFERENCE OUR QUICKSHIP PRICEBOOK FOR A COMPLETE LISTING OF AVAILABLE PRODUCT OFFERED ON OUR QUICKSHIP PROGRAM.



APTOS001

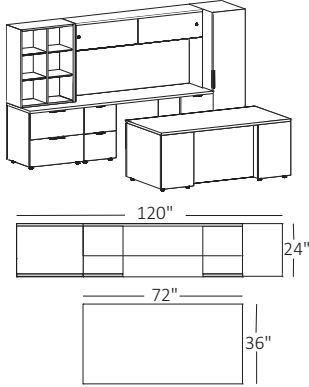

<u>Qty</u>	<u>Model Number</u>	<u>Description</u>	<u>List</u>
1	34-7236DPFT	72" x 36" Double Pedestal Desk, Breakfront	\$ 4,097
1	34-10224MCT	102" x 24" Modular Cabinet Top	\$ 1,254
1	34-2806BFP	Filler Panel	\$ 266
1	34-W1824MPD1	18" Modular Box/Box/File Pedestal	\$ 1,523
1	34-W1824MPD3	18" Modular File/File Pedestal	\$ 1,475
1	34-W3024MPD3	30" Modular Lateral File Pedestal	\$ 1,489
1	34-7239HG2	72" Highback Organizer with 2 Sliding Glass Doors	\$ 4,076
1	34-3039DS15	30" Worksurface Cabinet, Open	\$ 2,126
1	34-1868RSC1	18"W Tall Storage Wardrobe, Right	\$ 2,875
Total			\$ 19,181

Note: Pricing is for standard veneer. Locking is not included.

APTOS002

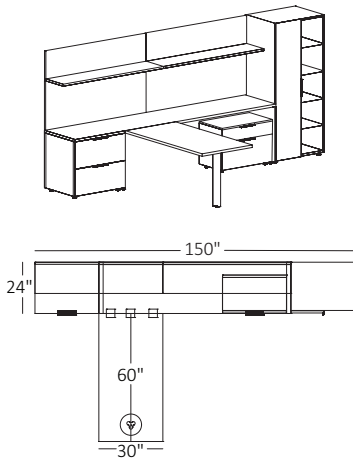

<u>Qty</u>	<u>Model Number</u>	<u>Description</u>	<u>List</u>
1	34-TFC	Trifoil Column	\$ 315
1	34-6030RT	60" x 30" Rectangular Runoff Worksurface	\$ 1,195
1	34-12024MCT	120" x 24" Modular Cabinet Top	\$ 1,572
1	34-2806BFP	Filler Panel	\$ 266
1	SCWBKT-1	16"L Worksurface Bracket	\$ 20
1	34-W3024MPD3	30" Modular Lateral File Pedestal	\$ 1,489
1	34-L3018MCT	30" x 18" Low Height Modular Cabinet Top	\$ 332
1	34-L3018MPD8	30" Low Height Modular Box/File Pedestal	\$ 1,273
2	34-6015WS	60" Wallmount Open Shelf Organizer	\$ 2,680
2	FTW2009	Tackboard for use with 60" Wallmount	\$ 1,228
1	34-3068LSC1	30"W Tall Open Storage with Hinged Door, Left	\$ 3,608
3	CP-1	4" x 4" Clamp Plate	\$ 36
Total			\$ 14,014

Note: Pricing is for standard veneer. Locking is not included.

APTOS003

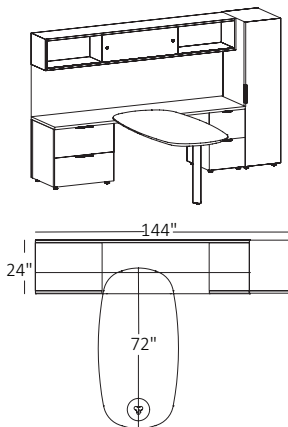

<u>Qty</u>	<u>Model Number</u>	<u>Description</u>	<u>List</u>
1	34-7236VTGOL	72" x 36" Eased Rectangle Glass Overlay Runoff Top	\$ 4,156
1	34-TFC	Trifoil Column	\$ 315
1	34-9615WSG1	96" Wallmount Organizer with Sliding Glass Door	\$ 3,568
1	FTW2003	Tackboard for use with 96" Wallmount	\$ 738
1	34-9624MCT	96" x 24" Modular Cabinet Top	\$ 1,159
1	34-2806BFP	Filler Panel	\$ 266
1	34-W1824MPD1	18" Modular Box/Box/File Pedestal	\$ 1,523
1	34-W3024MPD3	30" Modular Lateral File Pedestal	\$ 1,489
1	34-1868RSC1	18"W Tall Storage Wardrobe, Right	\$ 2,875
Total			\$ 16,089

Note: Pricing is for standard veneer. Locking is not included.

APTOS004

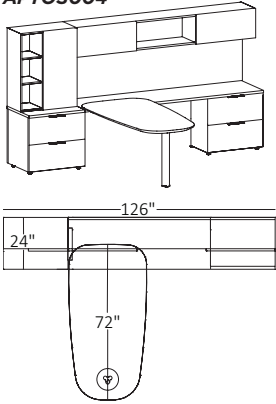

Qty	Model Number	Description	List
1	34-7236WTCOL	72" x 36" Wedge Solid Surface Overlay Runoff Top	\$ 4,364
1	34-TFC	Trifoil Column	\$ 315
1	34-9615WS2	96" Wallmount Organizer with 2 Lift Up Wood Doors	\$ 4,343
1	FTW2003	Tackboard for use with 96" Wallmount	\$ 738
1	34-9624MCT	96" x 24" Modular Cabinet Top	\$ 1,159
1	SCWBKT-1	16"L Worksurface Bracket	\$ 20
1	34-2806BFP	Filler Panel	\$ 266
1	34-W3024MPD3	30" Modular Lateral File Pedestal	\$ 1,489
1	34-3039RDS1	30" Asymmetrical Worksurface Cabinet Open Door, Right	\$ 2,276
1	34-3029LFC	30" 2 High Lateral File	\$ 1,758
Total			\$ 16,728

Note: Pricing is for standard veneer. Locking is not included.

APTOS005

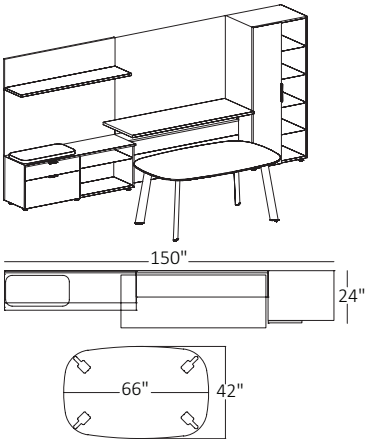

Qty	Model Number	Description	List
1	34-6726HARL	60" Height Adjustable Credenza, Left	\$ 4,759
1	34-L3018MPD8	30" Low Height Modular Box/File Pedestal	\$ 1,273
1	34-L3018MPD6	30" Low Height Modular Open Shelf Pedestal	\$ 799
1	34-L6018MCT	60" x 18" Low Height Modular Cabinet Top	\$ 596
1	34-L2806BFP	Low Height Filler Panel	\$ 254
1	34-6642VT	66" x 42" Eased Rectangle Table Desk Top	\$ 1,867
2	34-DFC	Duofoil Legs (set of 2)	\$ 970
1	4-6015WS	60" Wallmount Open Shelf Organizer	\$ 1,340
1	FTW2023	Tackboard for use with 60" Wallmount Organizer and Low Height Surface	\$ 688
1	FTW3047	60" Tackboard for use with No Wallmount and Low Height	\$ 795
1	34-3068LSC1	30"W Tall Open Storage with Hinged Door, Left	\$ 3,608
1	34-2914SC	29" x 14" Cushion	\$ 312
Total			\$ 17,261

Note: Pricing is for standard veneer. Locking is not included.

APTOS006

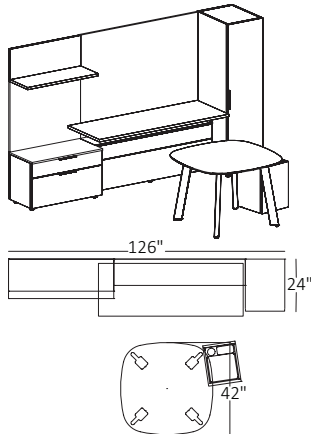

Qty	Model Number	Description	List
1	34-6726HARL	60" Height Adjustable Credenza, Left	\$ 4,759
1	34-L3618MCT	36" x 18" Low Height Modular Cabinet Top	\$ 370
1	34-L3618MPD8	36" Low Height Modular Box/File Pedestal	\$ 1,453
1	34-L2806BFP	Low Height Filler Panel	\$ 254
1	34-42SST	42" Eased Square Table Desk Top	\$ 1,164
2	34-DFC	Duofoil Legs (set of 2)	\$ 970
1	34-3615WS	36" Wallmount Open Shelf Organizer	\$ 896
1	FTW2027	Tackboard for use with 36" Wallmount Organizer and Low Height Surface	\$ 607
1	FTW3047	60" Tackboard for use with No Wallmount and Low Height	\$ 795
1	34-1 868RSC1	18"W Tall Storage, Right	\$ 2,875
1	34-1 518MPT	Mobile Ped with Grey Insert Tray	\$ 1,431
Total			\$ 15,574

Note: Pricing is for standard veneer. Locking is not included.

APTOS007

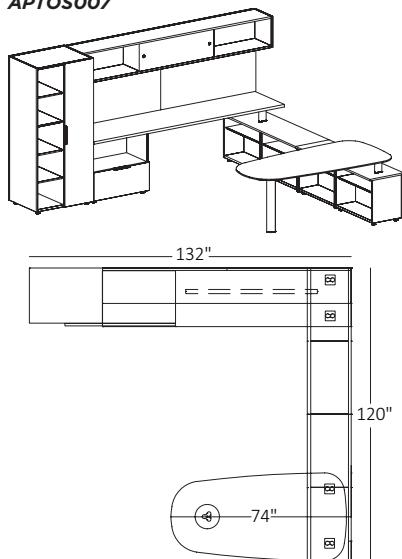

Qty	Model Number	Description	List
1	34-10215WSG1	102" Wallmount Organizer with Sliding Glass Door	\$ 3,732
1	FTW2002	Tackboard for use with 102" Wallmount Organizer	\$ 1,003
1	34-7236WTE	72" x 36" Elevated Runnoff Top, Wedge	\$ 1,874
4	34-DFS	Duofoil Standoffs	\$ 708
1	34-TFC	Trifoil Column	\$ 315
2	34-L6018MCT	60" Low Height Modular Cabinet Top	\$ 1,192
4	34-L3018MPD6	30" Low Height Modular Open Pedestal	\$ 3,196
1	34-L2806BFP	Low Height Filler Panel	\$ 254
1	34-10224MCT	102" X 24" Modular Worksurface	\$ 1,254
1	34-W3024MPD9	30" Modular Open/File Pedestal	\$ 1,257
1	34-3068RSCI	30"W Tall Open Storage with Hinged Door, Right	\$ 3,608
1	SPTR54	Worksurface Straightener, for unsupported Worksurface width 55" to 60"	\$ 44
Total			\$ 18,437

Note: Pricing is for standard veneer. Locking is not included.

APTOS008

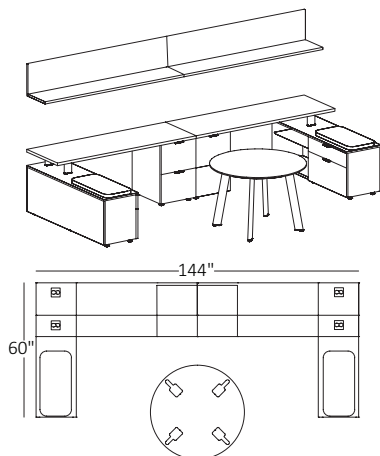

Qty	Model Number	Description	List
2	34-W1824MPD1	18" Modular Box/Box/File Pedestal	\$ 3,046
1	34-L6018FSL3	60" Open/Box/Lateral Floor Storage, Left	\$ 2,655
1	34-L6018FSR3	60" Box/Lateral/Open Floor Storage, Right	\$ 2,655
2	34-7224MCT	72" x 24" Modular Cabinet Top	\$ 1,644
1	34-42RT	42" Round Table Top	\$ 1,164
2	34-DFC	Duofoil Legs (set of 2)	\$ 970
2	34-DFS	Duofoil Standoff	\$ 354
2	34-7215WS	72" Wallmount Open Shelf Organizer	\$ 3,124
2	34-2914SC	29" x 14" Cushion	\$ 624
Total			\$ 16,236

Note: Pricing is for standard veneer. Locking is not included.

APTOS009

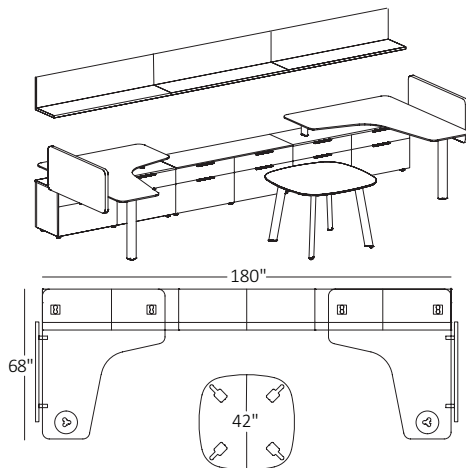

Qty	Model Number	Description	List
6	34-L3018MPD8	30" Low Height Modular Box/File Pedestal	\$ 7,638
3	34-L6018MCT	60" Low Height Modular Cabinet Top	\$ 1,788
2	34-L2806BFP	Low Height Filler Panel	\$ 508
1	34-6652SWTEL	66" x 52" Sweep Elevated Runnoff Worksurface, Left	\$ 1,980
1	34-6652SWTER	66" x 52" Sweep Elevated Runnoff Worksurface, Right	\$ 1,980
4	34-DFS	Duofoil Standoffs	\$ 708
1	34-42SST	42" Ease Square Table Desk Top	\$ 1,164
2	34-DFC	Duofoil Legs (set of 2)	\$ 970
3	34-6015WS	60" Wallmount Open Shelf Organizer	\$ 4,020
2	34-TFC	Trifoil Column	\$ 630
2	34-4420PPE	44" x 20" Fabric Edge Mount Privacy Panel	\$ 2,156
Total			\$ 23,542

Note: Pricing is for standard veneer. Locking is not included.

INTRODUCTION

FREESTANDING DESKS, CREDENZAS AND RETURNS

PEDESTALS

WORKSURFACES, RUNOFFS AND SUPPORTS

ABOVE WORKSURFACE STORAGE AND ADD-ONS

LATERAL FILE DRAWER, TOWERS AND BOOKCASES

OPEN PLAN

ACCESSORIES AND ELECTRICAL

ofs Aptos

TYPICALS

APTOS010

<u>Qty</u>	<u>Model Number</u>	<u>Description</u>	<u>List</u>
1	34-6830HALPD	66" x 30" Height Adjustable Left Peninsula	\$ 5,646
1	34-6830HALPD	66" x 30" Height Adjustable Right Peninsula	\$ 5,646
2	34-L3024MPD8	30" Box/File Pedestal	\$ 2,680
2	34-L3024MCT	30" x 24" Modular Cabinet Top	\$ 702
1	34-6015LWSG1NE	60" Wallmount Organizer with Open End and Sliding Glass Door, Left	\$ 2,912
1	34-6015RWSG1NE	60" Wallmount Organizer with Open End and Sliding Glass Door, Right	\$ 2,912
2	FTW2023	Tackboard for use with 60" Wallmount Organizer and Low Height Surface	\$ 1,376
1	34-3068SC1	30"W Tall Storage Tower	\$ 3,608
1	34-42RT	42" Round Table Top	\$ 1,164
2	34-DFC	Duofoil Legs (set of 2)	\$ 970
Total			\$ 27,616

Note: Pricing is for standard veneer. Locking is not included.

APTOS011

<u>Qty</u>	<u>Model Number</u>	<u>Description</u>	<u>List</u>
1	34-6018HAWC4	60" Height Adjustable End Cabinet	\$ 4,174
1	34-6006HAWC1	60" Height Adjustable Panel Base End	\$ 3,582
2	34-7230HASRT	72" x 30" Height Adjustable Soft Rectangle	\$ 4,474
1	34-72PRB	72" Cross Rail	\$ 693
1	34-5620PP	56" x 20" Surface Mount Fabric Privacy Screen	\$ 1,372
1	34-L4218FSL2	42" Low Height Pedestal/Open, Left	\$ 2,477
1	34-L4218FSR2	42" Low Height Pedestal/Open, Right	\$ 2,477
1	34-7215LWSG1NE	72" Wallmount Organizer with Open End and Sliding Glass Door, Left	\$ 3,240
1	34-7215RWSG1NE	72" Wallmount Organizer with Open End and Sliding Glass Door, Right	\$ 3,240
Total			\$25,729

Note: Pricing is for standard veneer. Locking is not included.

APTOS012

<u>Qty</u>	<u>Model Number</u>	<u>Description</u>	<u>List</u>
2	34-3018HAWC2	30" Height Adjustable End Cabinet with Open Shelf Back	\$ 8,178
1	34-3018HAWC5	30" Height Adjustable Middle Cabinet	\$ 4,487
4	34-7230HART	72" x 30" Height Adjustable Rectangle	\$ 7,724
2	34-72PRB	72" Cross Rail	\$ 1,386
2	34-5620PP	56" x 20" Surface Mount Fabric Privacy Screen	\$ 2,744
2	34-L4218FSL2	42" Low Height Pedestal/Open, Left	\$ 4,954
2	34-L4218FSR2	42" Low Height Pedestal/Open, Right	\$ 4,954
Total			\$ 34,427

Note: Pricing is for standard veneer. Electrical and Locking are not included.

4

TASK/PREVIEW LIGHT STANDARD FEATURES

- UL Listed

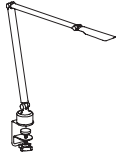

model	w	d	h	wt	cu ft	list
TL-20	7.7	6	15	2	1	\$ 535

- Energy Efficient LED 3500K Bulbs
- Silver Frame
- 6' Power Cord
- On/Off Touch Switch with Continuous Dimming
- Clamps to Rim of Worksurface - Cannot be used on Units with Back Panel

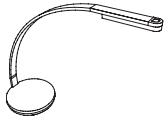

model	w	d	h	wt	cu ft	list
TL-S26B	6	18	15	3	2	Single \$ 360
TL-26B	6	18	15	4	2	Set of 2 \$ 683

- Available in Five Colors
- Desk Top with Free Standing Base
- 18 Fractional Watt Leds at 3500 K Color Temperature
- Feather Touch; ADA-Compliant Power and Light Level Control Switch
- Touch and Hold Dimming
- Auto Shut Off After Nine Hours of Continuous Use
- 9' Power Cord

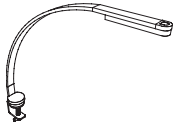

model	w	d	h	wt	cu ft	list
TL-S26C	2	18.13	17.5	3	2	Single \$ 365
TL-26C	2	18.13	17.5	4	2	Set of 2 \$ 692

- Available in Five Colors
- Clamps to Rim of Worksurface
- 18 Fractional Watt Leds at 3500 K Color Temperature
- Feather Touch; ADA-Compliant Power and Light Level Control Switch
- Touch and Hold Dimming
- Auto Shut Off After Nine Hours of Continuous Use
- 9' Power Cord

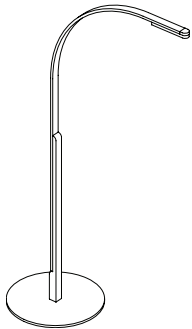

model	w	d	h	wt	cu ft	list
TL-S26F	10	22.63	40 - 50	8	5	\$ 683

- Floor Unit with Free Standing Base
- Available in Five Colors
- Height Adjustment from 40" - 50" from floor
- 18 Fractional Watt Leds at 3500 K Color Temperature
- Feather Touch; ADA-Compliant Power and Light Level Control Switch
- Touch and Hold Dimming
- Auto Shut Off After Nine Hours of Continuous Use
- 9' Power Cord

OPTIONS

Finish (Available on TL-S26B, TL-26B, TL-S26C, TL-26C and TL-S26F Only)

- C8G Black
- C8K Dark Slate
- C8H Silver
- C8J White
- H4F Red

MODEL NUMBER

TL-S26B

Finish

C8G

ACCESSORIES STANDARD FEATURES

PAPER CLIP HOLDER



model	w	d	h	wt	cu ft	list
SM2-10	3.25	2.25	1.63	1	1	\$ 49

PENCIL CUP



model	w	d	h	wt	cu ft	list
SM2-30	3.75	2.38	3.25	1	1	\$ 49

SMALL TRAY



model	w	d	h	wt	cu ft	list
SM2-40	7.88	5.5	1.5	2	1	\$ 49

PAPER TRAY

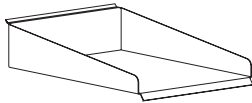

model	w	d	h	wt	cu ft	list
SM2-50	9.13	12.5	2.75	3	1	\$ 80

POST-IT-NOTE HOLDER



model	w	d	h	wt	cu ft	list
SM2-60	3.5	3.5	1.5	1	1	\$ 49

FOLDER TRAY

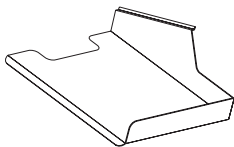

model	w	d	h	wt	cu ft	list
SM2-70	12.5	9.13	4.5	3	1	\$ 76

HOW TO ORDER

MODEL NUMBER

SM2-10



an OFS Brands™ company
1204 East Sixth Street
Huntingburg, IN 47542
T 800-521-5381
F 812-683-7256 (Orders)
F 812-683-7155 (CS)
ofs.com