

BRAVE™



Why Brave?

- Retro classic Winnebago exterior body styling
- Bold retro interior styling
- Powered StudioLoft™ beds
- LED lighting
- Innovative sliding dash Rearview Monitor/Rand McNally RV GPS
- MCD blackout roller shades
- Powered patio awning

WINNEBAGO™

BRAVE



Click on this icon throughout the brochure to link to more information on the web.

WINNEBAGO



On the Cover: 26A Mello Yellow Graphics

26A Good Vibrations with Cherry Cola Cabinetry

The 'Brow is Back!

In the late '60s and '70s, there was no mistaking a Winnebago motorhome. The bold Flying W and iconic "eyebrow" designs were cutting paths to fun and adventure from coast to coast. It was the coach that made America fall in love with motorhomes. Well, it's time to fall in love again. The new Brave™ breathes new life into the legendary design, giving you the opportunity to relive your childhood memories with the next

generation of motorhome enthusiasts. Beyond its stylish appearance, the new Brave is loaded with today's best features and versatile floorplans ideal for weekend getaways or extended trips. While you won't find one with the \$4,000 price tag of the original, it is priced to fit within a growing family's budget. Stand out. Be brave. The all-new Brave.



Recognized Quality The Recreation Vehicle Dealer Association annually rates RV manufacturers and awards the Quality Circle Award to manufacturers that provide exceptional products, service, and support. Winnebago is proud to be the only manufacturer that has received this award every year since its inception.



Best in Class

See how Winnebago takes motorhome design and function to the next level, and why we've earned the right to be called the Most Recognized Name in Motorhomes.®

 Click on this icon throughout the brochure to link to more information on the web.



The **Passenger Workstation** is the perfect place to plan the next leg of your trip.



Tie Down Anchors under the Flex Sofa/Bed provide extra storage flexibility and hold down your extra cargo while traveling.



Turn your cab into a second bedroom with the convenient **StudioLoft™** that drops down from the cab ceiling for another sleeping space.



A **Rearview Monitor System** with Rand McNally GPS slides side-to-side for easy access for driver and passenger.



The **Flex Sofa/Bed** in the 26A can flip tight against the wall for additional floor space. A powered table can even flip up with the sofa in this position to provide a work or serving surface.



Adjust your preferred light and privacy settings with the **MCD Blackout Roller Shades**.

BRAVE Lounge



The fun begins when you select an unforgettable '60s-inspired interior with Cherry Cola or Cream Soda wood choices. Never fear; while the Brave is a throwback in spirit, it is forward-thinking in execution. You won't find any shag carpet, but you will find easy-to-clean vinyl floor covering throughout the coach and a vinyl-clad ceiling. With swiveling cab seats and a removable pedestal table, you can easily set up for game night or simply have more space to lounge. You'll appreciate the easy-slide cabinet doors that make it easier to access your games and supplies with panels that slide open rather than flip up and down.



26A Good Vibrations with Cherry Cola Cabinetry



26A Easy-Slide Cabinet Door



26A Dinette



26A Removable Pedestal Table



26A Galley



26A Pantry



Refrigerator/Freezer



Backsplash



26A Flip-Up Countertop Extension

The galley is a true feast for the eyes, with retro styling paired with all the modern amenities that make today's motorhomes so popular. Cabinet doors with frosted panel inserts, waterfall laminate countertop and pull-out spring neck galley faucet offer a dash of contemporary styling that completes the look. Family meals are more fun in the U-shaped dinette found in the 27B and a removable pedestal table in the 26A and 31C complete your dining options.



26A Bedroom

While you may have fond memories of rolling out the sleeping bag on the floor of your parents' Winnebago, today's travelers demand more comfortable accommodations. That's why you'll find a queen bed in the 26A that converts to a single bed with a nightstand and a powered StudioLoft bunk bed. An additional StudioLoft bed in the front of the coach and, depending on which floorplan you choose, a sofa/bed or a dinette easily convert into beds for even more sleeping options.



26A Bedroom



26A Wardrobe



26A Bathroom



Dash

Here's something you didn't find in 1971: a Rand McNally GPS navigation system with Rearview Monitor. And talk about innovative; the monitor can slide directly in front of the passenger seat so your co-pilot can plan your route. The dash radio offers 30 programmable stations and Bluetooth™ connectivity so you can play music from your smartphone or tablet. At the end of the day, the fully-adjustable Primera covered cab seats swivel to face an already generous living area.



Passenger Workstation



Cab Seats



Powered Patio Awning

We hope you like making new friends because everyone at the campsite will want to check out your new Brave. So, grab a cold beverage and a comfortable lawn chair and enjoy the attention beneath the powered patio awning.

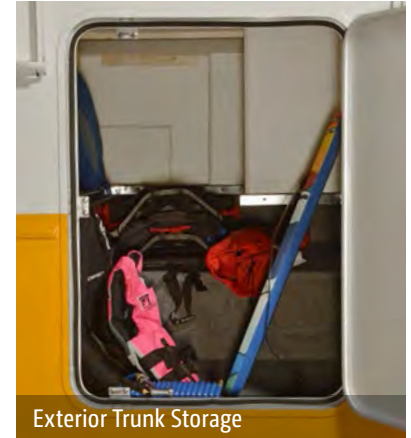

Exterior Trunk Storage



Automatic Entrance Steps



Powered Mirrors with Defrost



Stainless Steel Wheel Liners

Fiberglass Roof

The one-piece fiberglass roof is backed by a 10-year limited parts-and-labor roof skin warranty.

Rubber Can't Cut It

Rubber roofs used by competitors can streak and degrade over time.

Thermo-Panel® Sidewalls

By layering fiberglass and high-density block foam insulation with welded aluminum support structures, we create some of the industry's strongest, most durable and lightweight sidewalls.

E-Coating

An electrodeposition coating helps protect critical steel components.

Embedded Steel Metal substructures embedded into the sidewall provide solid attachment points to keep cabinets and appliances mounted securely in place.

Laser-Cut Tubing

Precision laser cutters create precise joints in structural steel that are stronger and require less welding.



Interlocking Joints

Specially engineered interlocking joints connect the floor, sidewalls and roof where competitors often rely on simple screws to bear the weight.



Solid Framework Aluminum extruded in our own facility to our exacting standards creates an extremely strong and solid structural framework.

**SUPER
STRUCTURE**

BUILT TO LAST

Every coach—from our smallest Class C to our largest diesel-pusher model—is built to Winnebago's® legendary SuperStructure® construction standards. It's a process developed and refined over more than 50 years of building some of the strongest, most durable coaches in the industry.



TESTING

Before rolling out of our factories, every coach undergoes an extensive 113-point inspection. Each coach also passes a high-pressure water test that simulates rain at a rate of 50-inches per hour to check for leaks. During the design process, our computer simulations, physical testing center, and rigorous test track ensure each model is built to last.



DETAILS

At Winnebago, we treat the features you can't see with the same care as the ones you can. Look in the access panels of some of our competitors' coaches and you'll see loose insulation and wires haphazardly strewn about. Winnebago maintains a clean fit and finish throughout so your coach will last for the long haul.



BUILT IN-HOUSE

We extrude our own aluminum. We rotocast our own plastic components. In fact, we manufacture most of our own parts so they are designed to fit the space, rather than fitting the space to an awkward off-the-shelf component size.

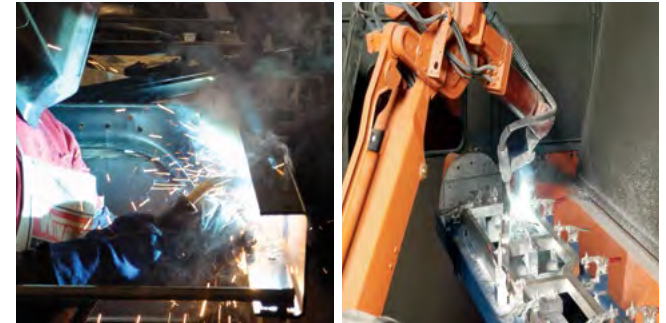

SUPER STRUCTURE[®]

BUILT TO LAST

 Visit BetterBuiltRVs.com to gain real insight into what goes into a Winnebago motorhome.

TAKE A TOUR

We're proud of our processes, state-of-the-art facilities, and the people who make Winnebago number one. We invite you to visit our complex in Forest City, Iowa, for a first-hand look at the dedication and technology behind every motorhome we build.



NEW 26A

The flex sofa/bed can flip up against the wall for additional floor space and also features a powered table that flips up to provide a large work or serving surface.

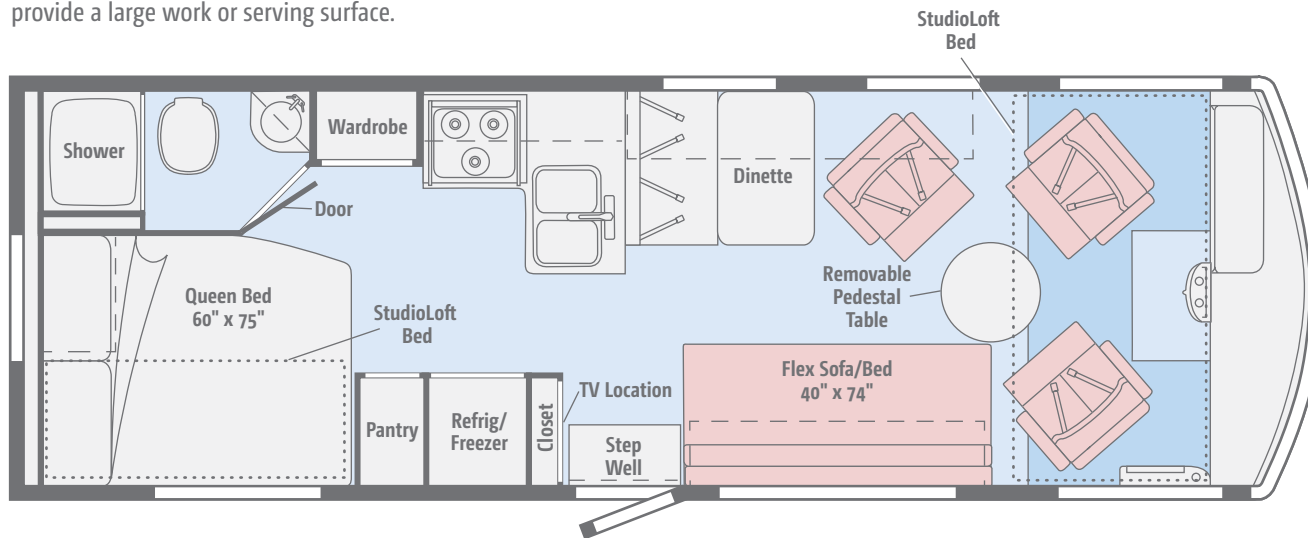

Dimensions shown are for sleeping space only and may vary due to styling differences. Dashed lines denote overhead storage areas. Floorplans and specifications are also available online at GoWinnebago.com.

NEW 27B

The U-shaped dinette sits in a generous slideout. It's a great place to enjoy a home-cooked meal and admire the retro styling.

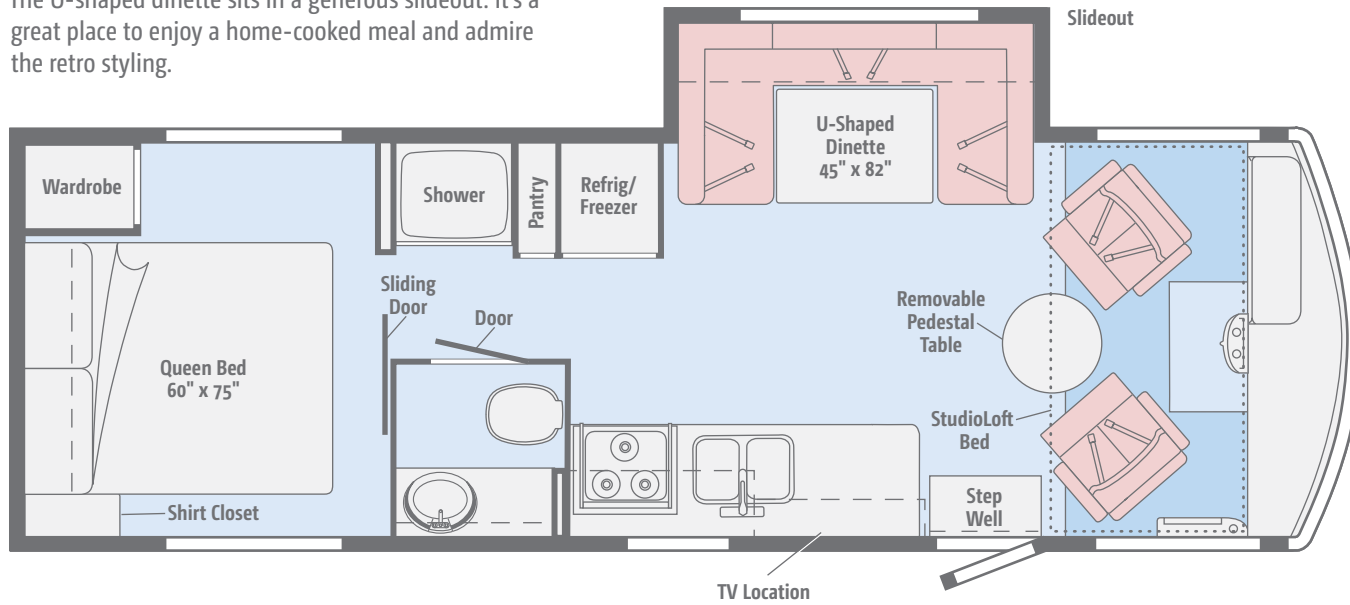

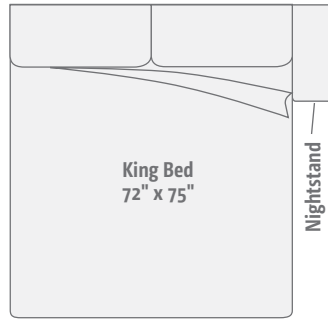

NEW 31C

The full-wall slideout allows for your choice of a king or queen bed, plus a full-size sofa bed facing a retractable HDTV.

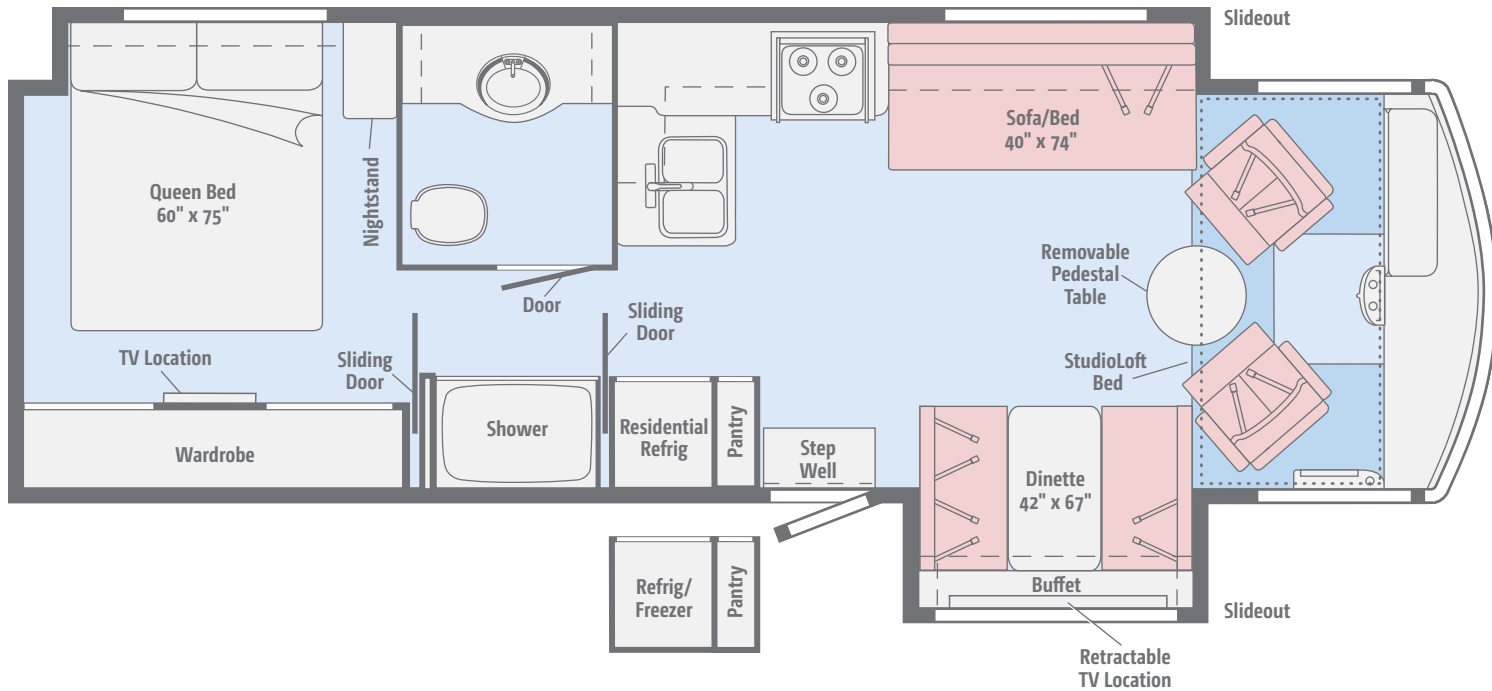



Choose from four retro fabric collections and two wood finishes.

Good Vibrations (NA with Crimson 'n Clover Exterior)



Primera



Primera Accent



Accent



Bedspread

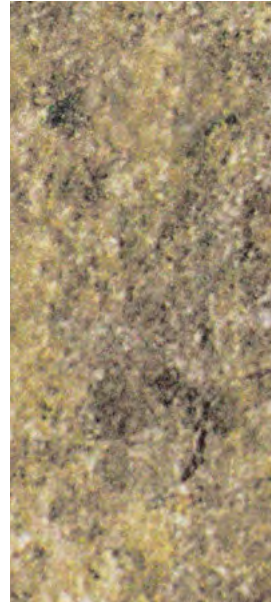

Countertop



Wall Board



Carpet

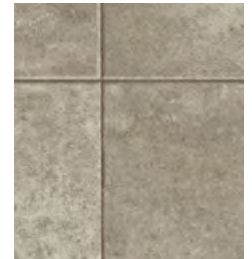

Vinyl

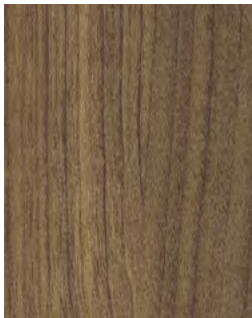

Cherry Cola

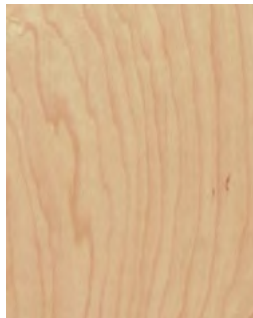

Cream Soda



Choose from four retro fabric collections and two wood finishes.

Calypso (Available with Crimson 'n Clover, Woodstock, and Aquarius Exteriors)



Primera



Primera Accent



Accent



Bedsread



Countertop

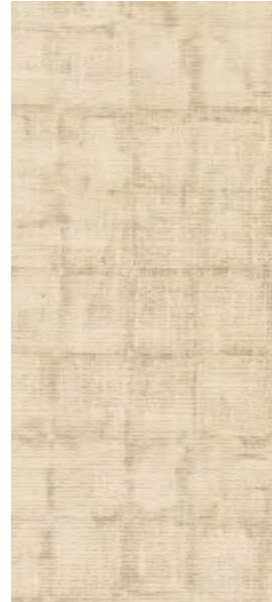

Wall Board



Carpet

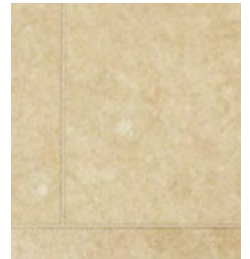

Vinyl

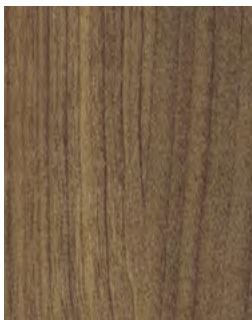

Cherry Cola



Cream Soda



Choose from four retro fabric collections and two wood finishes.

Moody Blue (NA with Crimson 'n Clover Exterior)

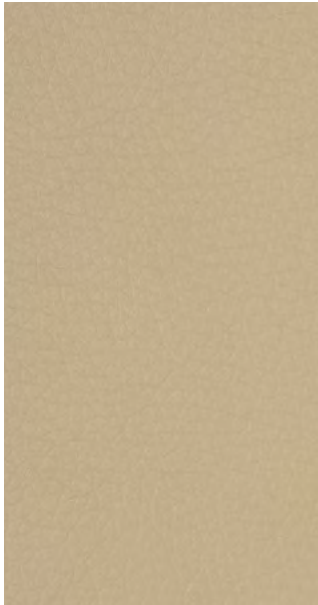

Primera



Primera Accent



Accent



Bedspread



Countertop



Wall Board



Carpet

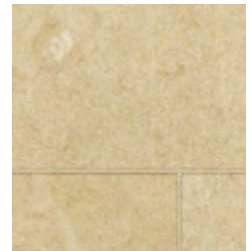

Vinyl



Cherry Cola



Cream Soda

Winnebago® reserves the right to change décor materials and specifications without notice or obligation.



Choose from four retro fabric collections and two wood finishes.

Corduroy (Available with Crimson 'n Clover and Woodstock Exteriors)

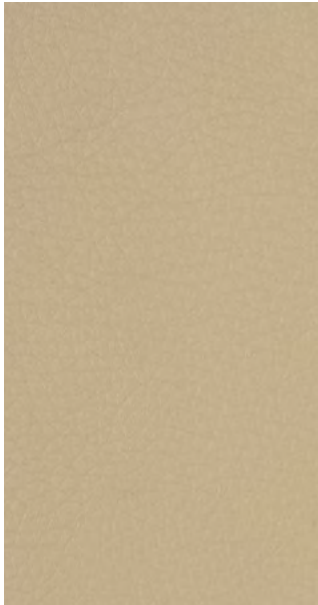

Primera



Primera Accent



Accent



Bedspread



Countertop



Wall Board



Carpet

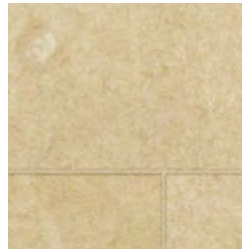

Vinyl



Cherry Cola



Cream Soda

Winnebago® reserves the right to change décor materials and specifications without notice or obligation.

BRAVE Graphics



WINNEBAGO[®]

Choose from five groovy graphics packages.



Woodstock
(Available with all Interiors)



Bell Bottom Blue
(Available with Good Vibrations and Moody Blue Interiors)



Aquarius
(Available with Moody Blue, Good Vibrations, and Calypso Interiors)



Mello Yellow
(Available with Good Vibrations and Moody Blue Interiors)



Crimson 'n Clover
(Available with Calypso and Corduroy Interiors)