

**STEP BY STEP INSTRUCTIONS
FOR THE AMT 102V AND 103V**

AMT 102V and 103V comes with
all items shown:

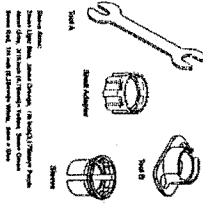

For additional instructions or information contact:
Quality Control at CUI INC
800.275.4498
www.cui.com
Complete specifications
www.cui.com/specs
www.amtmotor.com

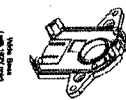

STEP 1

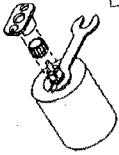

1. Place the unit on a flat surface. Use the provided wrench to remove the top cover. The top cover is secured with two screws. The top cover is shown in the diagram.

STEP 2

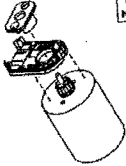

2. Remove the motor from the motor mount. The motor is shown in the diagram.

STEP 3

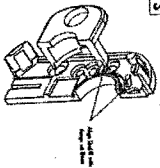

3. Place the motor into the motor mount. The motor is shown in the diagram.

STEP 4

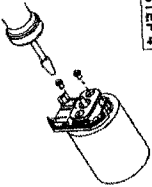

4. Tighten the motor to the motor mount. The motor is shown in the diagram.

STEP 5



5. Place the top cover back onto the unit. The top cover is shown in the diagram.

STEP 6



6. Place the unit back into the motor mount. The unit is shown in the diagram.